

# CLIPPER



## **CARPET EXTRACTOR**



Operating Instructions

**MODEL: CLP12**

**QUEST**® ... for Continuous Improvement.  
Windsor's Quality Management System is Certified ISO 9001.



*Read these instructions before operating the machine*



# TABLE OF CONTENTS

|                        |       |
|------------------------|-------|
| MODEL                  | _____ |
| DATE OF PURCHASE       | _____ |
| SERIAL NUMBER          | _____ |
| SALES REPRESENTATIVE # | _____ |
| DEALER NAME            | _____ |

---

|   |      |                                       |       |
|---|------|---------------------------------------|-------|
| <i>Data Log/Table of Contents</i> ..... | 1    | <i>Maintenance</i> .....              | 16-18 |
| <i>Safety Instructions</i> .....        | 2    | <i>Technical Specifications</i> ..... | 19    |
| <i>Grounding Instructions</i> .....     | 3    | <i>Service Schedule</i> .....         | 20    |
| <i>Controls</i> .....                   | 4-6  | <i>Parts Lists</i> .....              | 21-34 |
| <i>Operations</i> .....                 | 7-13 | <i>Spare Parts/Notes</i> .....        | 35    |
| <i>Troubleshooting</i> .....            | 14   | <i>Warranty</i> .....                 | 36    |
| <i>Wiring Diagram</i> .....             | 15   |                                       |       |

---

## **INSPECTION**

Carefully unpack and inspect your machine for shipping damage. Each unit is operated and thoroughly inspected before shipping, and any damage is the responsibility of the carrier, who should be notified immediately.

## IMPORTANT SAFETY INSTRUCTIONS

**When using an electrical appliance, basic precaution must always be followed, including the following:**

**READ ALL INSTRUCTIONS BEFORE USING THIS MACHINE.**

**This machine is for commercial use.**



**To reduce the risk of fire, electric shock, or injury:**

Connect to a **properly grounded outlet**. See Grounding Instructions.

**Do not** leave the machine unattended. Unplug machine from outlet when not in use and before maintenance or service.

**Use only** indoors. Do not use outdoors or expose to rain.

**Do not** allow machine to be used as a toy. **Close attention** is necessary when used by or near children.

**Use only** as described in this manual. Use only manufacturer's recommended components and attachments.

**Do not** use damaged electrical cord or plug. Follow all instructions in this manual concerning grounding the machine. If the machine is **not working properly**, has been dropped, damaged, left outdoors, or dropped into water, return it to an authorized service center.

**Do not** pull or carry machine by electrical cord, use as a handle, close a door on cord, or pull cord around sharp edges or corners.

**Do not** run machine over cord. **Keep** cord away from heated surfaces.

**Do not** unplug machine by pulling on cord. To unplug, grasp the electrical plug, not the electrical cord.

**Do not** handle the electrical plug or machine with wet hands.

**Do not** operate the machine with any openings blocked. Keep openings free of debris that may reduce airflow.

This machine is intended for cleaning carpet only.

**Do not** vacuum anything that is burning or smoking, such as cigarettes, matches, or hot ashes.

This machine is not suitable for picking up health endangering dust.

Turn off all controls before unplugging.

**Machine can cause a fire** when operating near flammable vapors or materials. Do not operate this machine near flammable fluids, dust or vapors.

**This machine is suitable for commercial use, for example in hotels, schools, hospitals, factories, shops and offices for more than normal housekeeping purposes.**

Maintenance and repairs must be done by qualified personnel.

If foam or liquid comes out of machine, switch off immediately.

## SAVE THESE INSTRUCTIONS

# GROUNDING INSTRUCTIONS

THIS PRODUCT IS FOR COMMERCIAL USE ONLY.

## ELECTRICAL:

In the USA this machine operates on a standard 15 amp 115V, 60 hz, A.C. power circuit . The amp, hertz, and voltage are listed on the data label found on each machine. Using voltages above or below those indicated on the data label will cause serious damage to the motors.

## GROUNDING INSTRUCTIONS:

This appliance must be grounded. If it should malfunction or break down, grounding provides a path of least resistance for electric current to reduce the risk of electric shock. This appliance is equipped with a cord having an equipment-grounding conductor and grounding plug. The plug must be inserted into an appropriate outlet that is properly installed and grounded in accordance with all local codes and ordinances.

This appliance is for use on a nominal 115-volt circuit, and has a grounded plug that looks like the plug in "Fig. A". A temporary adaptor that looks like the adaptor in "Fig . C" may be used to connect this plug to a 2-pole receptacle as shown in "Fig. B", if a properly grounded outlet is not available. The temporary adaptor should be used only until a properly grounded outlet (Fig. A) can be installed by a qualified electrician. The green colored rigid ear, lug, or the like extending from the adaptor must be connected to a permanent ground such as a properly grounded outlet box cover. Whenever the adaptor is used, it must be held in place by a metal screw.

## PROPER GROUNDING

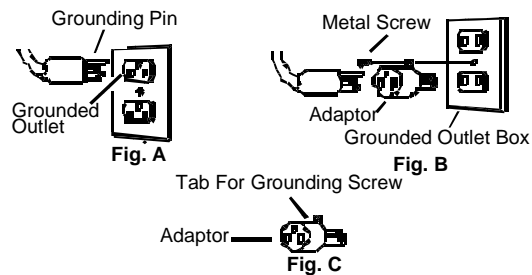

**NOTE: In Canada, the use of a temporary adaptor is not permitted by the Canadian Electrical Code**



Improper connection of the equipment-grounding conductor can result in a risk of electric shock. Check with a qualified electrician or service person if you are in doubt as to whether the outlet is properly grounded. Do not modify the plug provided with the appliance - if it will not fit the outlet, have a proper outlet installed by a qualified electrician.

## CONTROLS/COMPONENT LOCATIONS

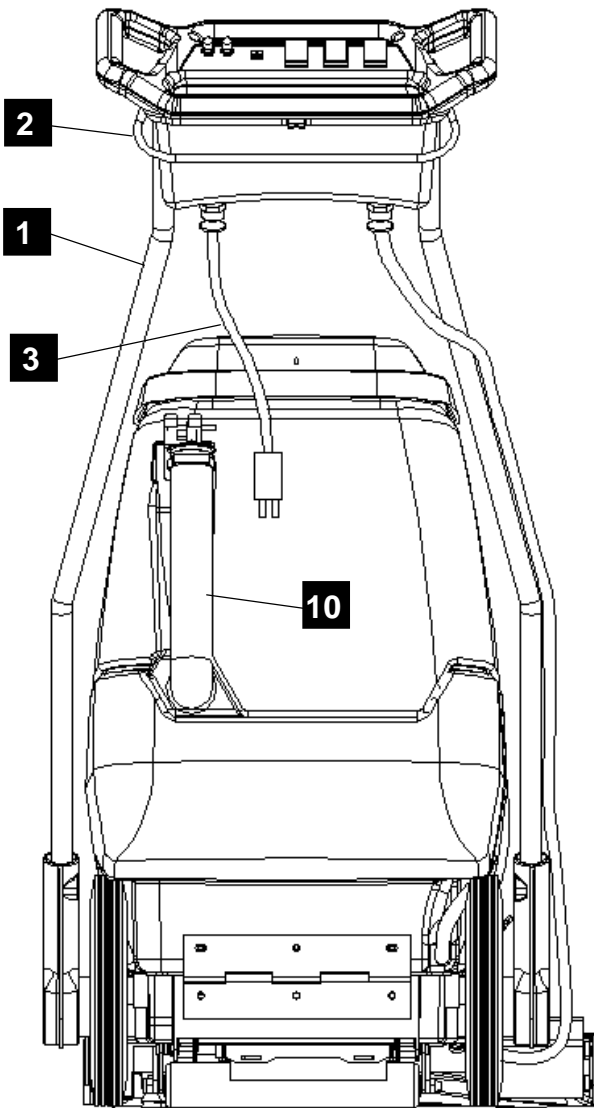
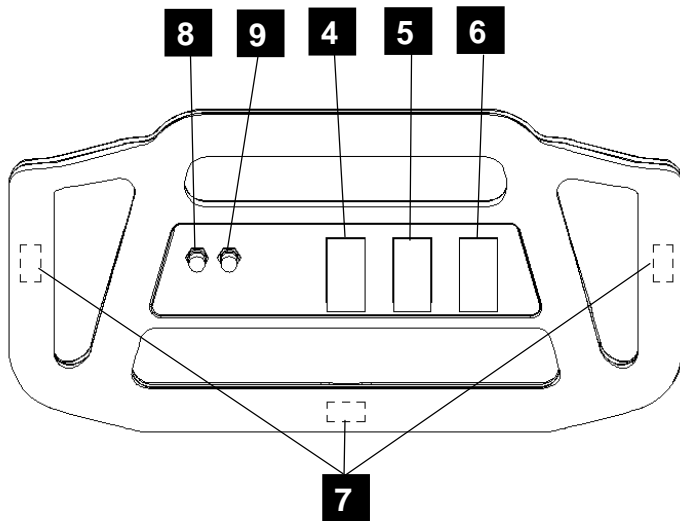

- 1. Main Handle.** Used to pull and maneuver machine.
- 2. Handle Adjustment.** Used to adjust height of handle, and allow machine to be used in "PUSH" or "PULL" orientation.
- 3. Electrical Cord.**
- 4. Solution Switch.** Turns on pump. Continuous position (bottom) activates electro-valve to dispense solution to floor through jets. Intermittent position (up) requires operator to depress 1 of 3 trigger switches to dispense solution. Center position is off.
- 5. Brush Motor Switch.** Turns on brush motor.
- 6. Vacuum Motor Switch.** Turns on vacuum motor.
- 7. Trigger Switches.** Activates electro-valve to dispense solution to floor through jets when solution switch is in the intermittent position.
- 8. Brush Motor Circuit Breaker.** 6 amp. Breaker protecting brush motor.
- 9. Vacuum Motor Circuit Breaker.** 15 amp. Breaker protecting vacuum motor.
- 10. Recovery Dump Hose.** Facilitates draining dirty cleaning solution.

## CONTROLS/COMPONENT LOCATIONS

- 1. Solution Accessory Tool Hookup.** Used for various auxiliary cleaning tools.
- 2. Vacuum Hose Door.** Used to connect various auxiliary 1 ½ inch cleaning tool vacuum hoses.
- 3. Brush Height Adjustment.** Used to regulate brush height from storage position to various carpet heights.
- 4. Recovery Tank.** Used to collect dirty cleaning solution.
- 5. Solution Tank.** Used to hold cleaning solution.
- 6. Solution Dump Hose.** Facilitates draining excess cleaning solution from solution tank.
- 7. Recovery Tank Dome.**
- 8. Solution Tank Lid.**
- 9. Solution Tank Fill Hose.**
- 10. Vacuum Shoe.**
- 11. Brush Housing.**
- 12. Front Lifting Handle.**
- 13. Cleaning Solution Filter.**

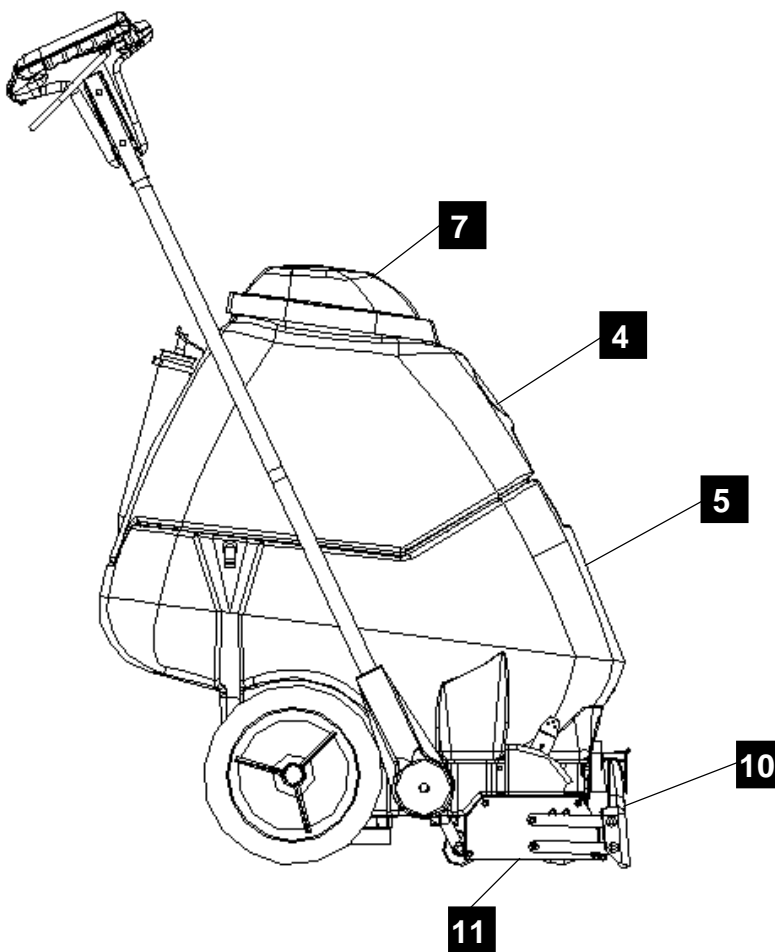
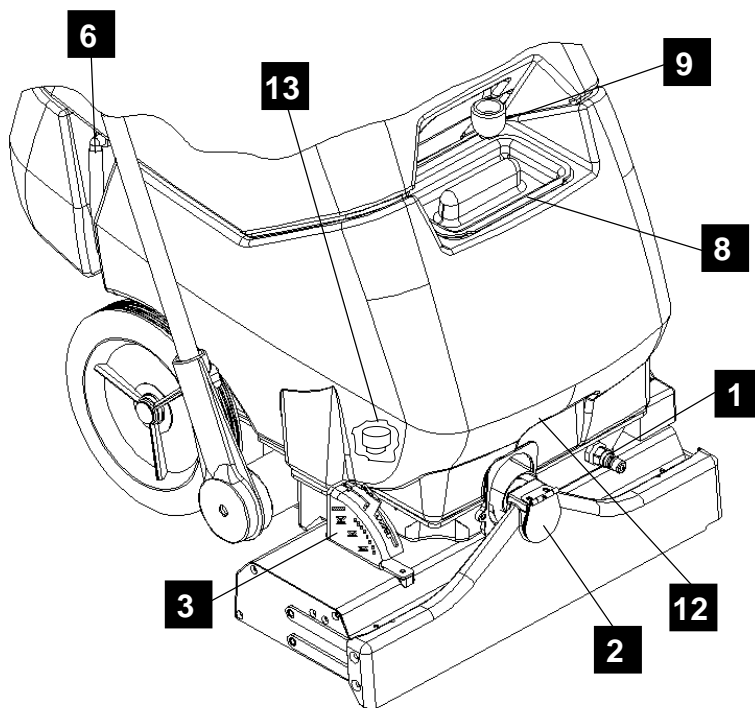

## CONTROLS/COMPONENT LOCATIONS

1. Solution Intake Cover.
2. Vacuum Intake Cover.
3. Float Shut-Off.
4. Clean-Out Opening.
5. Pour Spout.
6. Lift Handle.

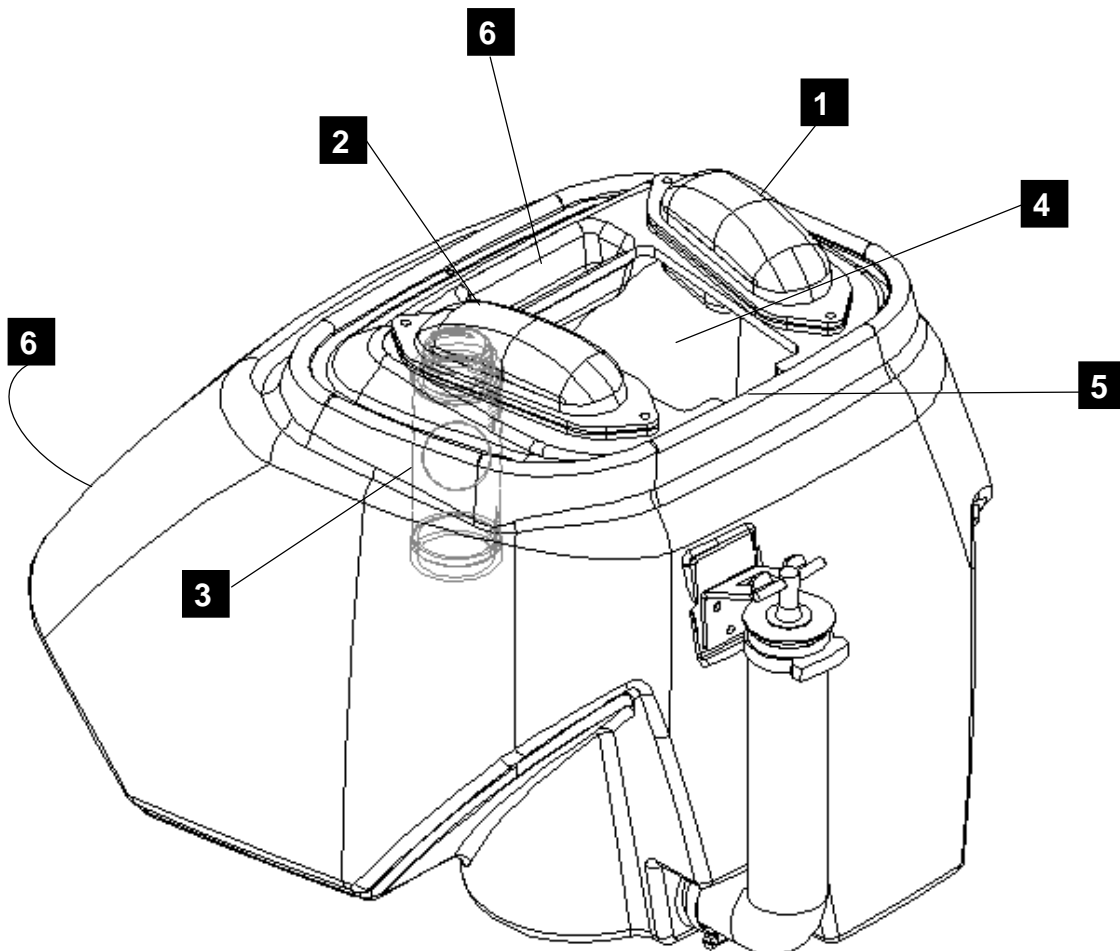

# FILLING OPERATIONS

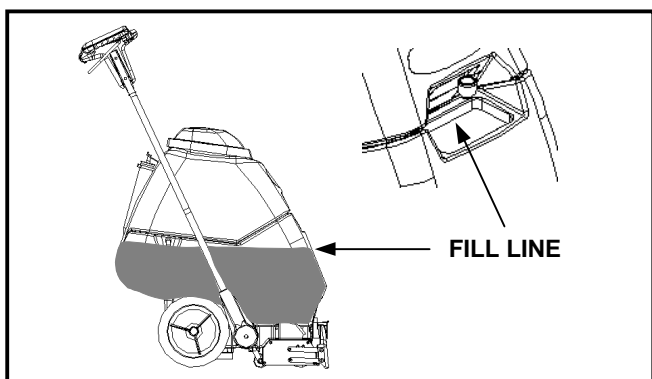
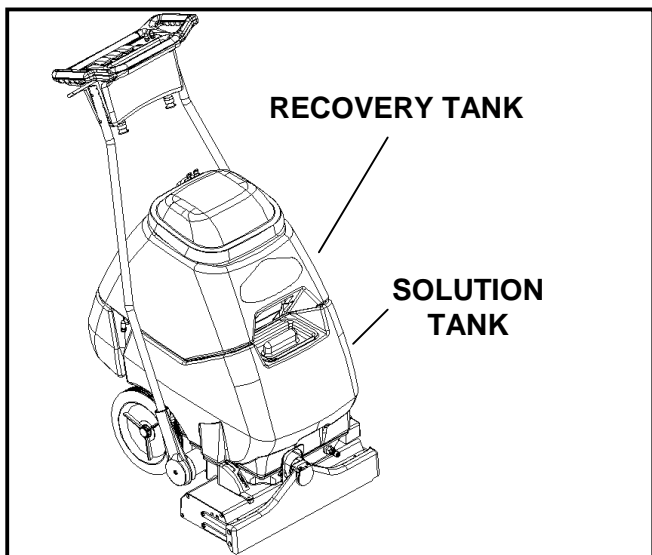

## FILLING THE CLIPPER

NOTE: Use clean bucket of water to fill solution tank

Do not put defoamer, solvents, spotter or prespray chemicals in the solution tank.

Do not allow water to spill into vacuum motor inlet. Dry spillage from top of solution tank before replacing recovery tank.

## CHEMICALS

### Suitable Chemicals

Alkalis  
Detergents  
Hydroxides  
Soaps  
Vinegar

### Non-Compatible Chemicals

Aldehydes  
Aromatic Hydrocarbons  
SP Butyls  
Carbon Tetrachloride  
Clorox\*  
Chlorinated Bleaches  
Chlorinated Hydrocarbons  
Lysol\*  
Methyl Ethel Ketone (MEK)  
Perchorethylene (perc)  
Phenolics  
Trichlorethylene  
D-Limonene

STEP  
1

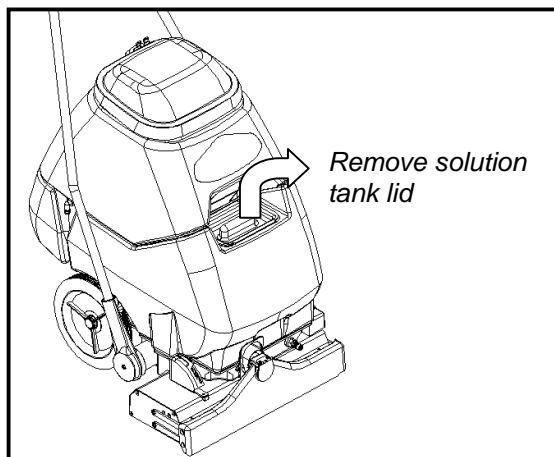

STEP  
2

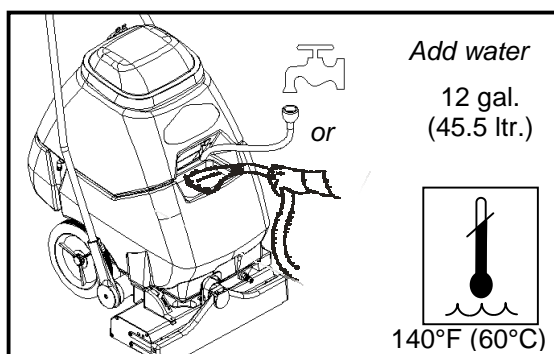

STEP  
3

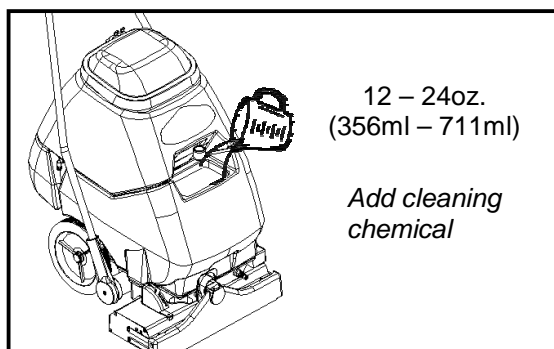

STEP  
4

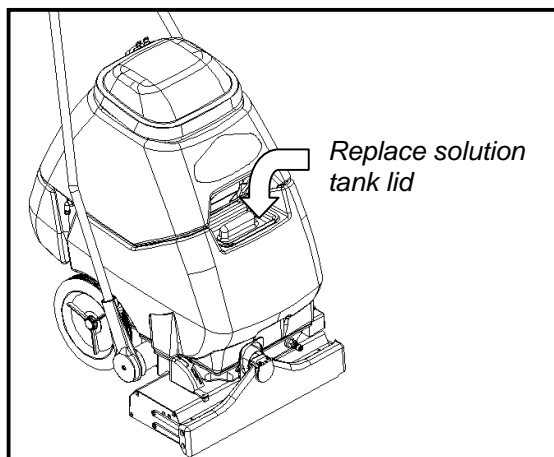



# OPERATIONS

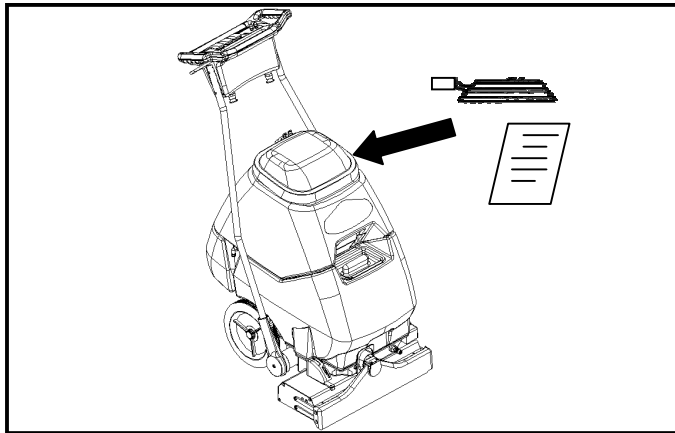

STEP  
1

Remove electrical cord and literature from recovery tank. Fill solution tank (see filling instructions page 7).

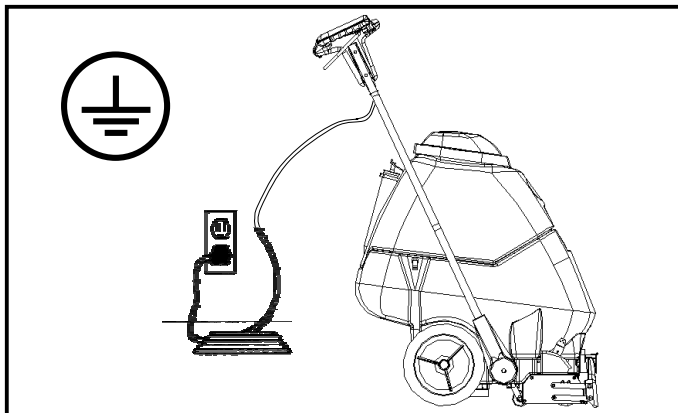

STEP  
2

Plug cord into grounded outlet. *Note: Be sure dome is seated on recovery tank, and float shut-off is installed correctly.*

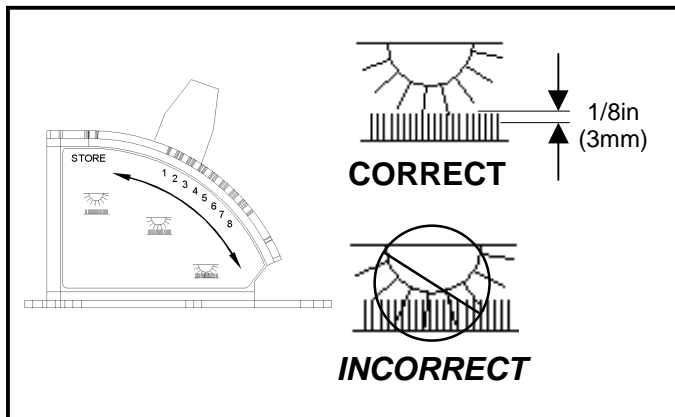

STEP  
3

Adjust brush to proper setting. *Note: For good operation the brush must skim the carpet. If circuit breaker trips raise brush to prevent damage to motor or carpet.*

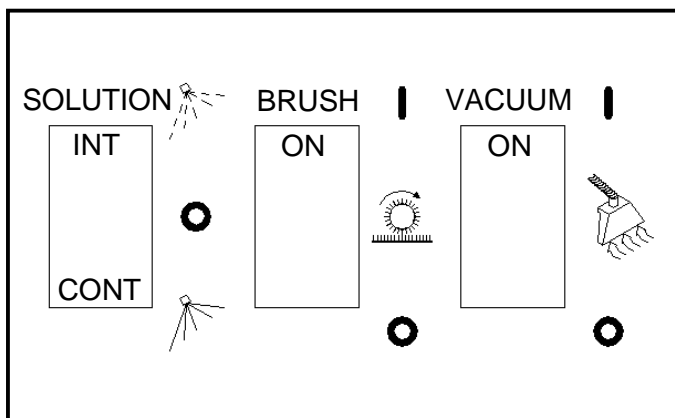

STEP  
4

Turn on brush and vacuum motor switches ("ON"="I"). Turn on solution switch for continuous spray or set switch to intermittent to allow use of trigger switches.

## OPERATIONS

Adjust handle to comfortable operating position. Tip machine back by main handle to move to starting point.

STEP  
5

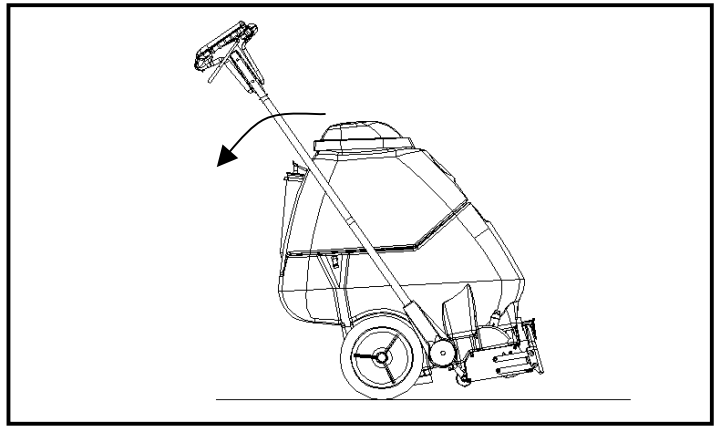

Lower machine to floor.

STEP  
6

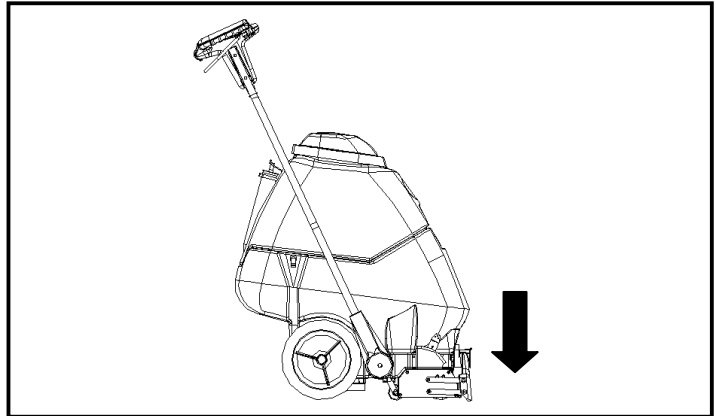

Select continuous setting to start solution spray or select intermittent setting to enable use of trigger switches to start solution spray. The intermittent setting requires the operator to hold any one of the three trigger switches in the “on” position with the fingers, and is typically used in small areas where short cleaning passes are made. The continuous setting allows the operator to set the switch in the “on” position with one touch, and is typically used in large areas where long cleaning passes are made.

STEP  
7

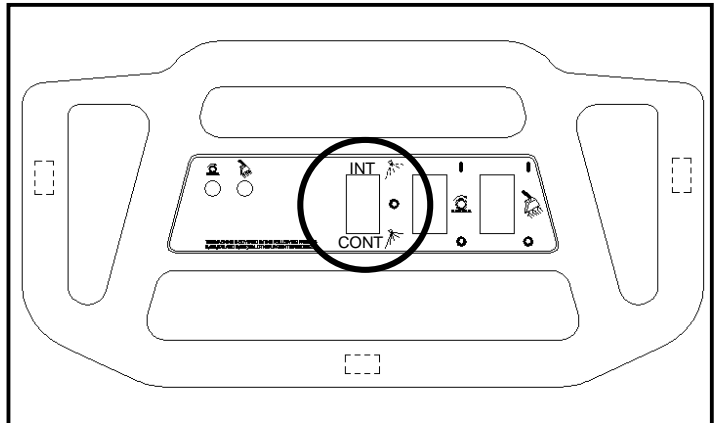

## CLEANING PROCEDURE

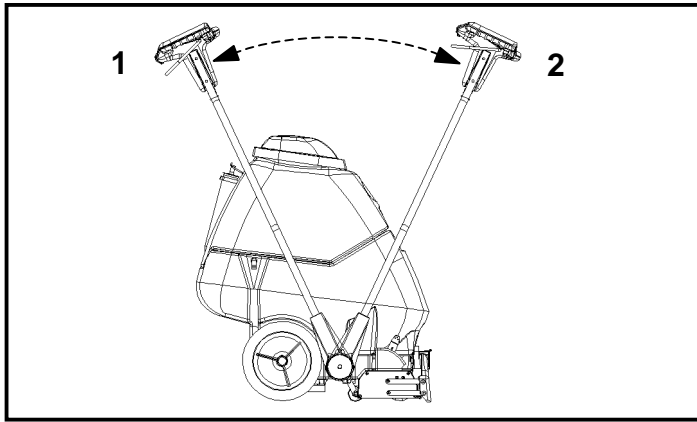

1. This machine can be operated in either direction. For smaller areas operate the machine by pulling rearward.
2. For larger unobstructed areas, flip the handle and use the machine's brush assisted propelling motion.

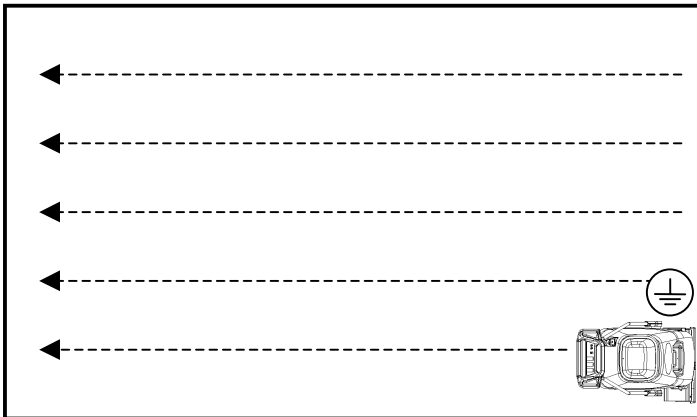

STEP  
**1**

Start at wall closest to power outlet. For small areas, pull straight back without pushing down on handle.

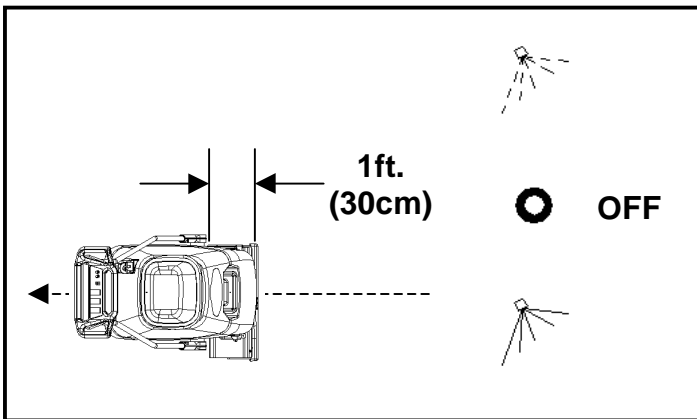

STEP  
**2**

Release intermittent trigger switches or turn off continuous setting on solution switch approximately 1 foot before ending cleaning pass.

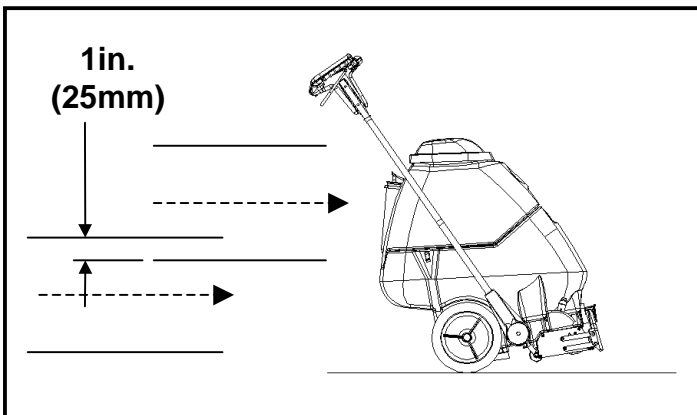

STEP  
**3**

Push down on handle to raise vacuum shoe and brush before moving to the next cleaning pass. Overlap brush contact area approximately 1 inch.

## CLEANING PROCEDURE

Start at wall closest to power outlet.  
For large areas flip handle and operate machine in parallel passes, overlapping brush path. Clean perimeter last.

OR

STEP  
1

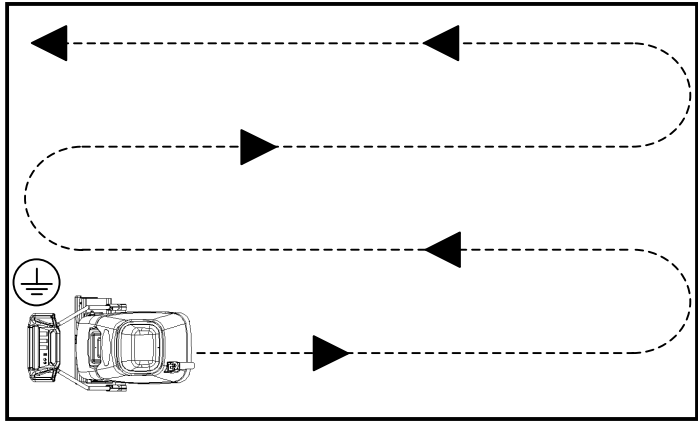

During operation, observe the following: The Clipper is equipped with clear internal covers to facilitate operator viewing of dirty solution and vacuum air flow.

During operation, observe the vacuum intake cover. Large amounts of water or foam entering the vacuum system can damage the vacuum motor. If you notice either condition, **shut down the machine immediately**. Empty recovery tank and/or add defoamer to recovery tank.

STEP  
4

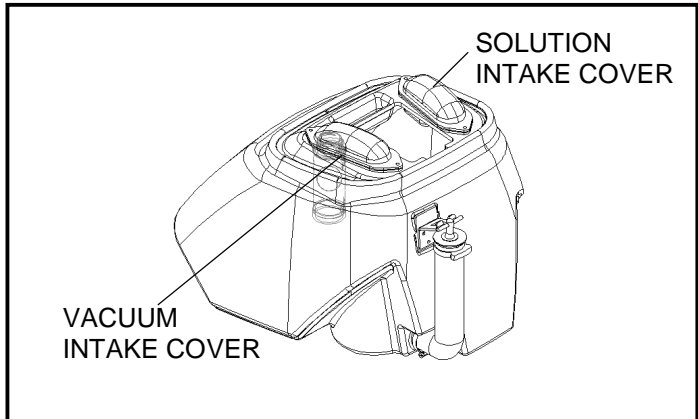

Use right side of machine for cleaning against walls.

STEP  
5

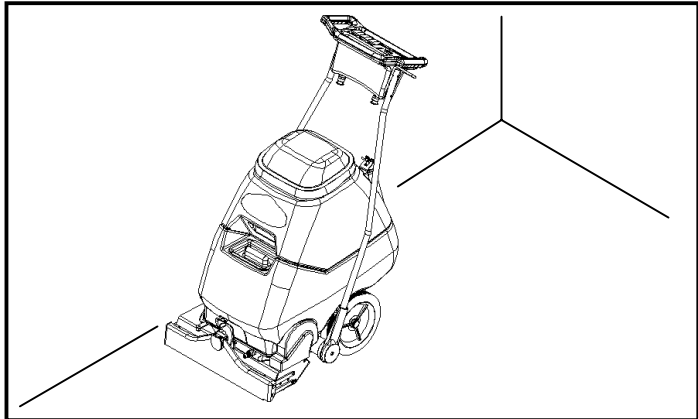

After cleaning, turn off all controls, return brush to storage position and carefully unplug machine.

STEP  
6

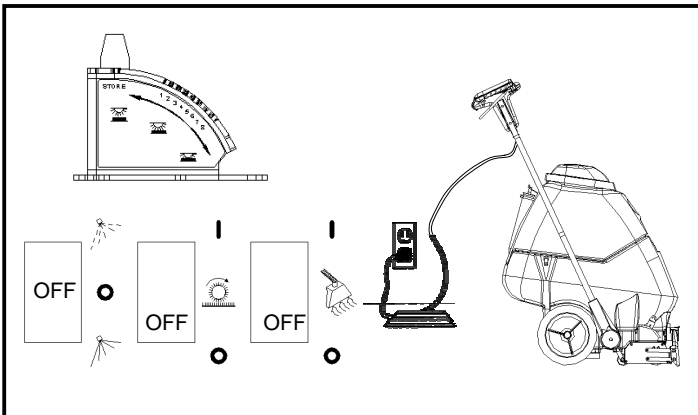

## CLEANING PROCEDURE

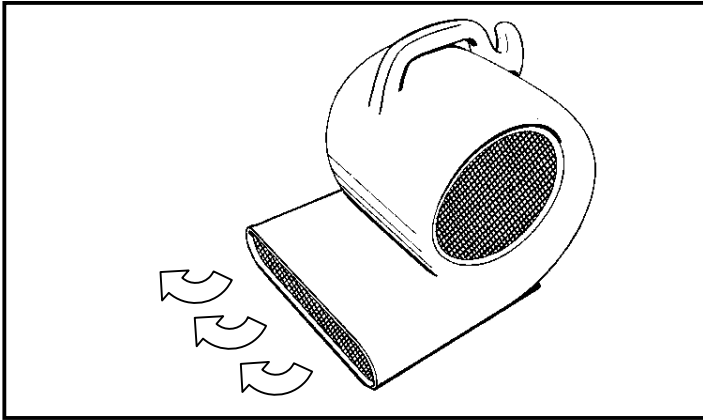

**STEP 7** To speed drying, use a Windblower™ fan.

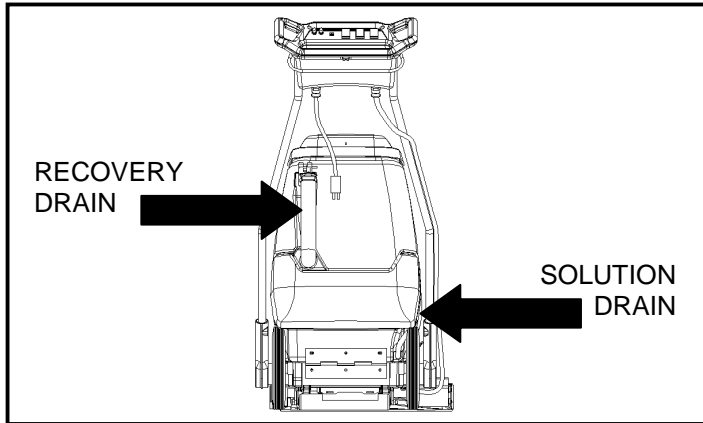

**STEP 8** Empty recovery tank by releasing dump hose. Use a hose with cold water to clean out the recovery tank. Also drain solution tank after each use.

## ACCESSORY TOOL USAGE

Use only one of the following acceptable accessory tools.

CST DDH DH DHT UPH-3  
SW SW-PRO SFW 39504

Pull back collar and insert over machine mounted fitting, then release collar to lock into place.

STEP  
1

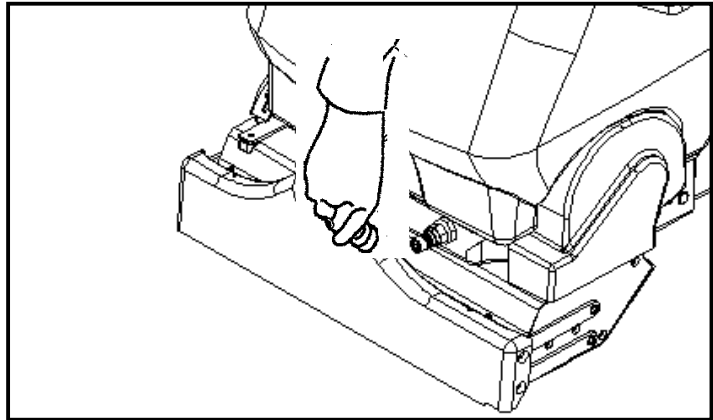

Lift door on front of vacuum shoe and insert 1 ½ inch hose cuff into hole.

STEP  
2

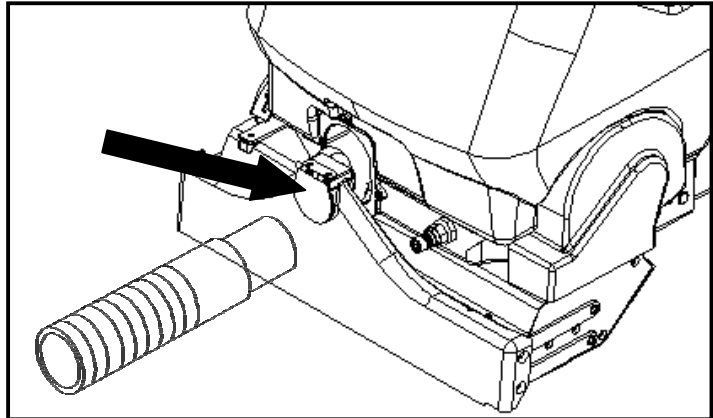

Turn on vacuum motor switch and set solution switch to intermittent position. *Note: Be sure brush switch is in off position and brush is in storage position.*

STEP  
3

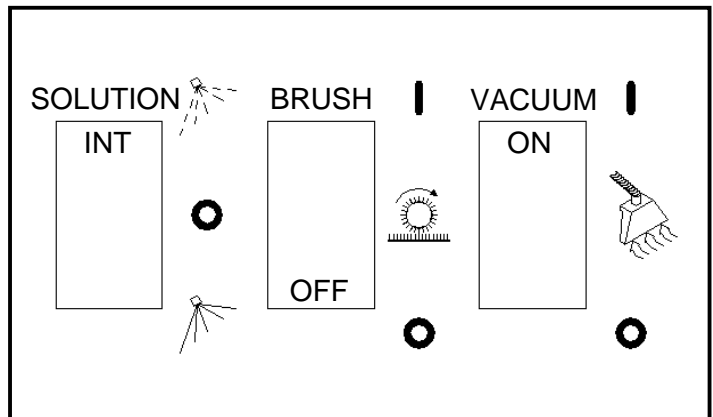

Squeeze handle on accessory tool to begin cleaning.

STEP  
4

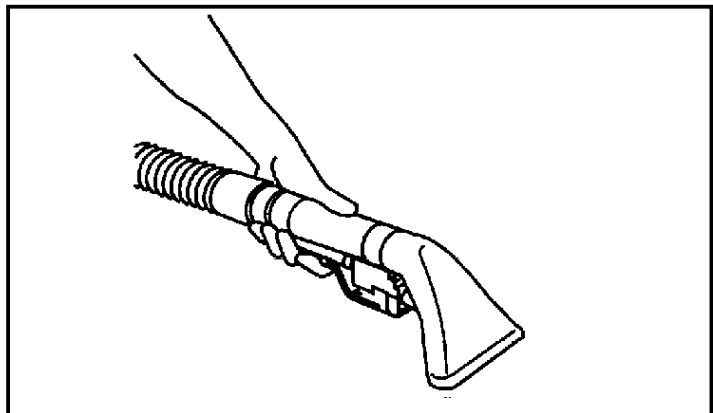

## TROUBLESHOOTING CHART

| <b>PROBLEM</b>                            | <b>CAUSE</b>  | <b>SOLUTION</b>  |
|---|---|--|
| No Power, Nothing Runs                    | <ol style="list-style-type: none"> <li>1. Is the cord plugged in.</li> <li>2. Circuit breaker tripped in building.</li> <li>3. Faulty switch.</li> <li>4. Faulty power cord or pigtail.</li> </ol>  | <ol style="list-style-type: none"> <li>1. Plug in cord.</li> <li>2. Reset breaker</li> <li>3. Call for service.</li> <li>4. Call for service.</li> </ol>   |
| Vacuum Motor Will Not Run                 | <ol style="list-style-type: none"> <li>1. Vacuum circuit breaker tripped.</li> <li>2. Faulty main vacuum switch.</li> <li>3. Loose wiring.</li> <li>4. Faulty vac motor.</li> </ol>   | <ol style="list-style-type: none"> <li>1. Reset breaker</li> <li>2. Call for service.</li> <li>3. Call for service.</li> <li>4. Call for service.</li> </ol>   |
| Vacuum Motor Runs But Suction Is Poor     | <ol style="list-style-type: none"> <li>1. Debris lodged in vac shoe.</li> <li>2. Dome gasket defective or missing.</li> <li>3. Vacuum hose cracked or hose cuff loose.</li> <li>4. Recovery tank full / float ball stuck in the up position.</li> </ol> | <ol style="list-style-type: none"> <li>1. Remove debris from vac shoe.</li> <li>2. Replace as necessary.</li> <li>3. Replace or repair as necessary.</li> <li>4. Turn off vac motor. Drain and rinse recovery tank.</li> </ol> |
| Poor Or No Water Flow (Carpet Is Streaky) | <ol style="list-style-type: none"> <li>1. Main pump switch off.</li> <li>2. Jets clogged or missing.</li> <li>3. Solution filter clogged.</li> <li>4. Faulty solenoid.</li> </ol>   | <ol style="list-style-type: none"> <li>1. Turn on.</li> <li>2. Clean using a vinegar /water solution or replace.</li> <li>3. Drain solution tank and clean solution filter.</li> <li>4. Call for service.</li> </ol>           |
| Brush Does Not Spin                       | <ol style="list-style-type: none"> <li>1. Brush switch off.</li> <li>2. Brush circuit breaker tripped</li> <li>3. Brush belt broken.</li> <li>4. Faulty brush motor.</li> </ol>   | <ol style="list-style-type: none"> <li>1. Turn on brush switch.</li> <li>2. Reset circuit breaker.</li> <li>3. Replace as necessary.</li> <li>4. Call for service.</li> </ol>  |

# WIRING DIAGRAM

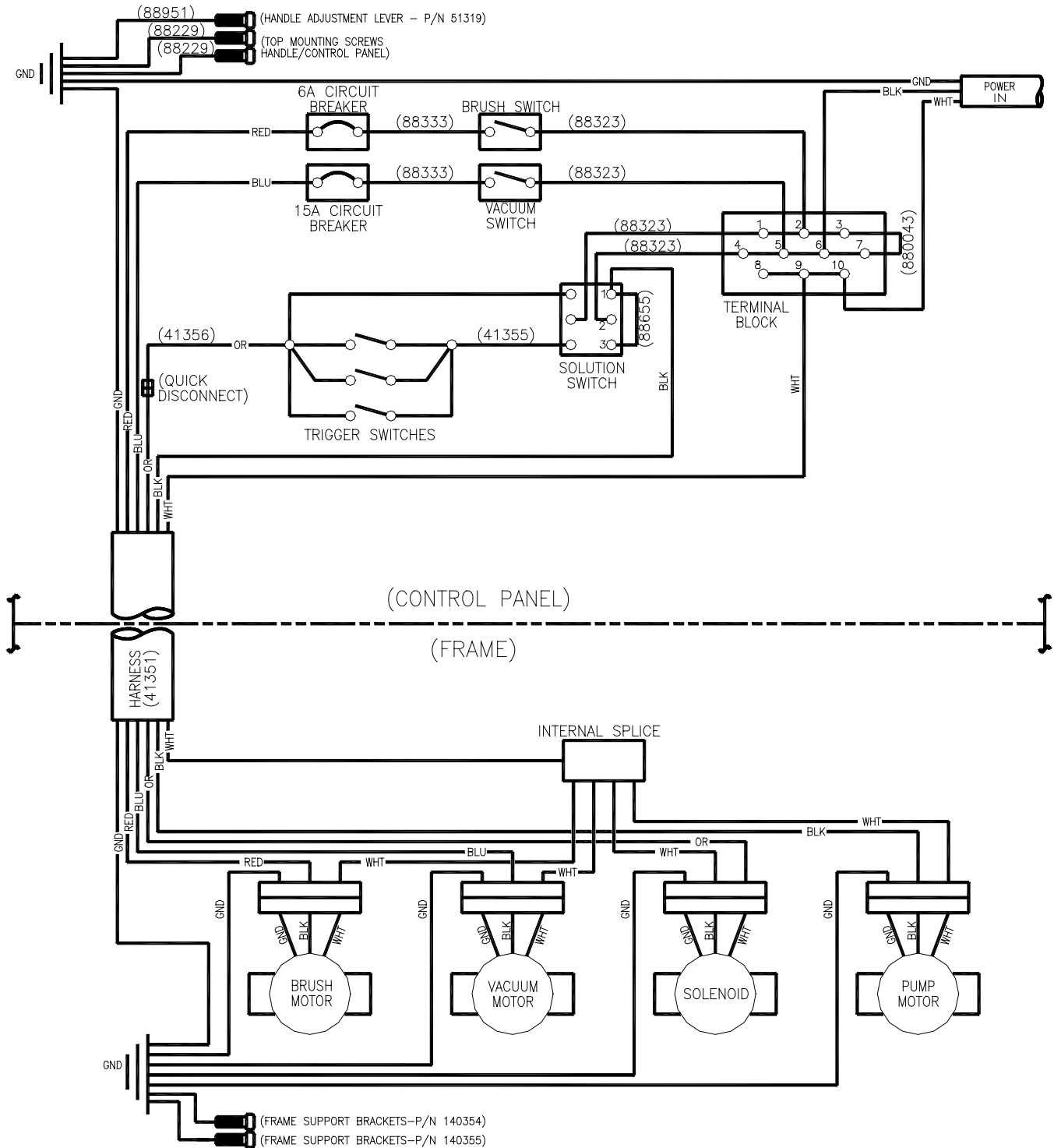



## **PERIODIC MAINTENANCE**

Twice a month, flush a white vinegar solution (One quart vinegar to two gallons of water) or anti-browning solution (mixed as directed) through the extractor. This will prevent build-up of alkaline residue in the system. If spray jets become clogged, remove the spray tips, wash them thoroughly, and blow-dry.

*NOTE: Do not use pins, wire, etc. to clean nozzles as this could destroy spray pattern.*

Periodically inspect all hoses, electrical cables and connections on your machine. Frayed or cracked hoses should be repaired or replaced to eliminate vacuum or solution pressure loss. If the cable insulation is broken or frayed, repair or replace it immediately. Don't take chances with electrical fire or shock.

## **DAILY / REGULAR MAINTENANCE**

Before making any adjustments or repairs to the machine, disconnect the power cord from electrical source.

1. Empty unused cleaning solution from the solution tank.
2. Inspect and clean filter screen in solution tank.
3. Flush pumping system with 4 or 7 liters of clean, hot water.
4. After each use, rinse tank with fresh water. Periodically inspect the recovery tank and decontaminate if necessary, using a Hospital Grade Virucide or a 1-10 bleach to water solution. Waste water should be disposed of properly.
5. Check for and remove any lint or debris around vac shoe.
6. Check spray jets for full spray pattern.
7. Remove lint and dirt build-up from brush and housing.

*NOTE: Brush removal.*

- A. To remove brush, grab and pull brush out from end opposite drive belt (operator's right). Remove other end from brush driver.
- B. To install brush, line up slots in brush core with pin in driver on drive belt side (operator's left) and push brush onto driver. Then snap bearing end (opposite end) of brush into retaining clip.

8. Check cooling air screen (located on frame behind left wheel) for lint or debris.
9. Check float and shut-off screen and clean as necessary.

*NOTE: Always store machine with brush in "Store" position.*

# MAINTENANCE



## WARNING:

**ONLY QUALIFIED  
MAINTENANCE  
PERSONNEL ARE TO**

**PERFORM THE FOLLOWING REPAIRS.**

### VACUUM MOTOR REPLACEMENT

1. Turn off all switches and unplug machine.
2. Remove recovery tank.
3. Remove the (2) screws that fasten the solution tank to the frame, and tilt tank back to expose the inside of the frame.
4. Locate the vacuum motor wires and disconnect at the connector. Close the solution tank.
5. Remove the (6) screws holding the vacuum motor cover (p/n 27809) to the solution tank.
6. Remove the vacuum motor.
7. Reverse process to install vacuum motor.

### BELT REPLACEMENT

1. Turn off all switches and unplug the machine.
2. Remove recovery tank.
3. Remove the (2) screws that fasten the solution tank to the frame, and tilt tank back to expose the inside of the frame.
4. Remove solution hoses from fittings in pump.
5. Remove the (2) screws that fasten the pump to the frame.
6. Reverse process to install pump.

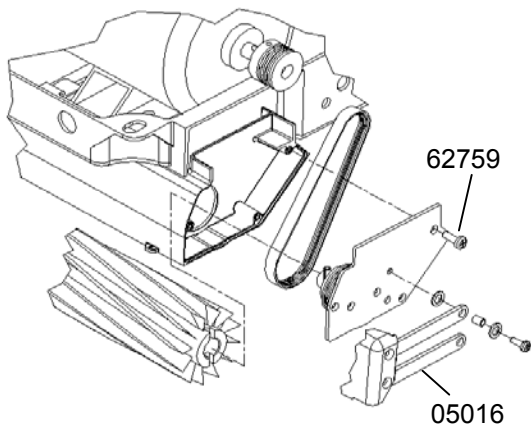

### Vac Motor Carbon Brushes Replacement

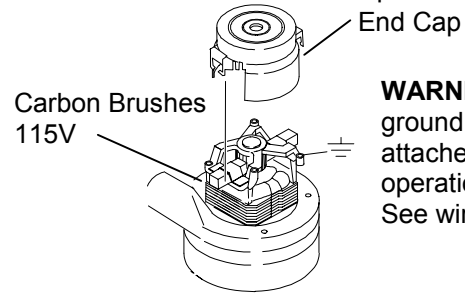

**WARNING:** The green ground wire must be attached for safe operation. See wiring diagram.

**Note:** When replacing carbon vac motor brushes loosen wire terminal **BEFORE** removing screws on bracket.

If armature commutator is not concentric, extremely pitted, or grooved the motor will need to be replaced or sent to a qualified service center to restore vac performance.

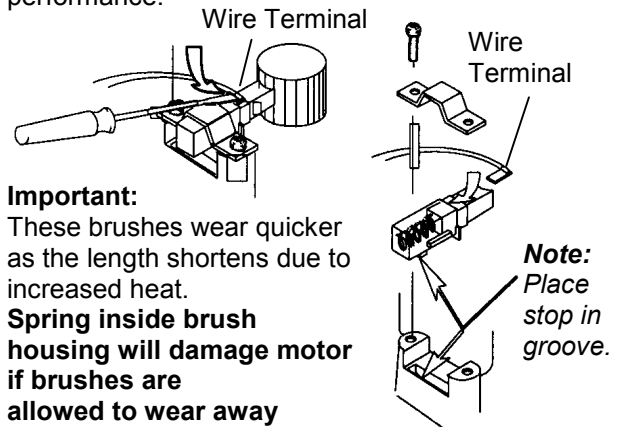

**Important:** These brushes wear quicker as the length shortens due to increased heat. **Spring inside brush housing will damage motor if brushes are allowed to wear away completely.**

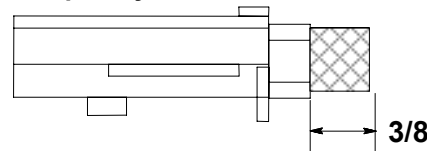

Periodically check the length of the carbon brushes. Replace both carbon brushes when either is less than 3/8" long.



## WARNING:

ONLY QUALIFIED MAINTENANCE PERSONNEL ARE TO PERFORM THE FOLLOWING REPAIRS.

### SOLUTION PUMP REPLACEMENT

1. Turn off all switches and unplug the machine.
2. Remove recovery tank.
3. Remove the (2) screws that fasten the solution tank to the frame, and tilt tank back to expose the inside of the frame.
4. Remove solution hoses from fittings in pump.
5. Remove the (2) screws that fasten the pump to the frame.
6. Reverse process to install pump.

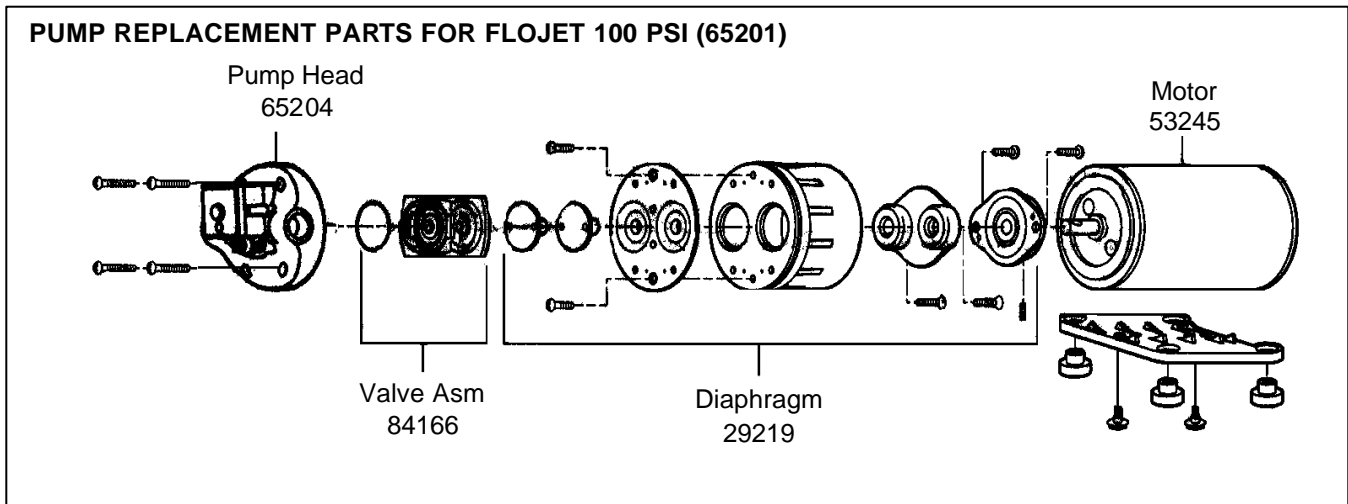

# TECHNICAL SPECIFICATIONS

## POWER TYPE

**ELECTRICAL:** 115 V, 15 A, 60 HZ

**ELECTRIC VACUUM MOTOR:** (1) –3 stage, 1 hp, 99 cfm (2.80 cubic meters/min.) Waterlift –117" (297cm)

**BRUSH:** (1) 18" (45.7 cm.)

**SOLUTION PUMP:** 100 PSI, diaphragm style, internal bypass

**SOLUTION CAPACITY:** 12 gallons (45.5ltr)

**RECOVERY CAPACITY:** 12 gallons (45.5ltr)

**BRUSH SPEED:** 1000 rpm

## GENERAL DIMENSIONS/WEIGHT

**Vacuum shoe:** 20" (51 cm) cast aluminum with spring loaded down pressure

**WHEELS:** (2) 10" dia. (25 cm) wheels by 2"

**WEIGHT:** 105lbs. (48kg)

**LENGTH:** 28" (71 cm)

**HEIGHT:** 46" (117 cm)

**WIDTH:** 24" (61 cm)

**SOLUTION SPRAY:** 2 quick change jets.

**POWER CABLE:** 50' (12.7 m) (14 gauge)

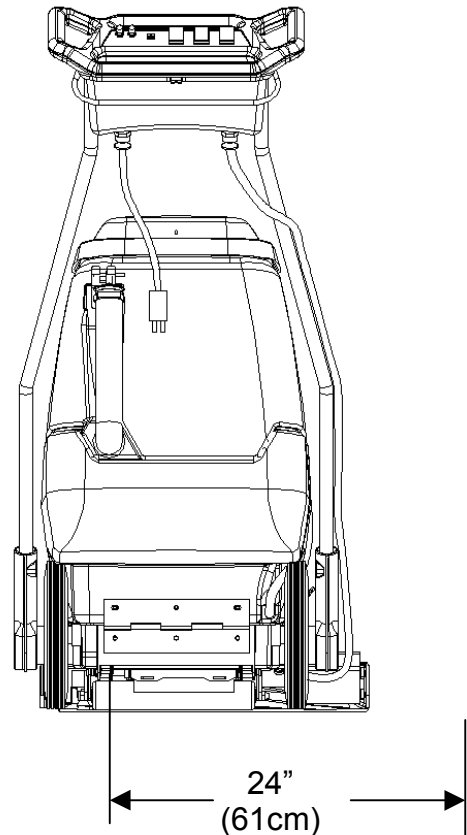
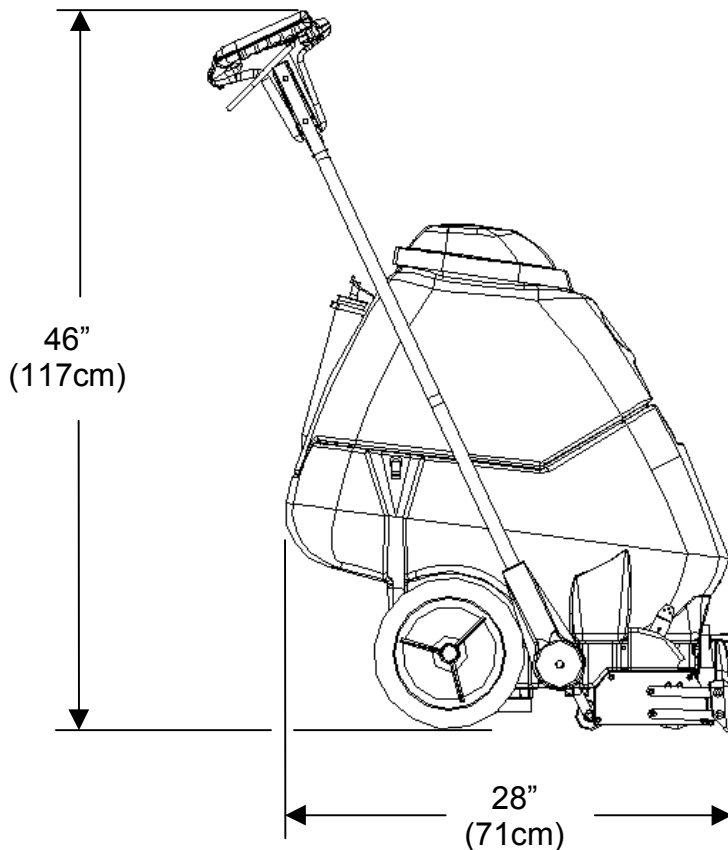

**SERVICE SCHEDULE**

| <b>MAINTENANCE</b>   | <b>DAILY</b> | <b>WEEKLY</b> | <b>QUARTERLY</b> |
|--|--------------|---------------|------------------|
| Check machine for cord damage  | *            |               |                  |
| Check recovery dome and gasket for damage and cleanliness                    | *            |               |                  |
| Check brush – should be clean with no lint or strings attached               | *            |               |                  |
| Inspect vac shoe for blockage; remove fibers with coat hanger, etc.          | *            |               |                  |
| Check hoses for wear, blockages, or damage                                   | *            |               |                  |
| Check handles, switches, and knobs for damage                                | *            |               |                  |
| Check vac motor intake filter and clean                                      | *            |               |                  |
| Run one gallon of water through system                                       | *            |               |                  |
| Clean out recovery tank and check float valve to make sure it moves freely   | *            |               |                  |
| Clean out solution tank and remove and clean vacuum intake screen            | *            |               |                  |
| Clean outside of all tanks and check for damage                              | *            |               |                  |
| Run vac motor for at least one minute to allow motor to dry                  | *            |               |                  |
| Store with dome off tank to allow the tank to dry                            | *            |               |                  |
| Check all bearings for noise   |              | *             |                  |
| Check all gaskets for wear and leakage                                       |              | *             |                  |
| Check vacuum intake screen for damage; replace if necessary                  |              | *             |                  |
| Check pump pressure; observe spray pattern and check with gauge if necessary |              | *             |                  |
| Check and clean solution screen  |              | *             |                  |
| Check belts for wear and replace as necessary                                |              | *             |                  |
| Check brush for wear; ensure bristles are not damaged                        |              | *             |                  |
| Check cables for fraying   |              | *             |                  |
| Check the spray bar (manifold) for damage; replace if broken or bent         |              | *             |                  |
| Check condition of vac shoe and frame for damage                             |              | *             |                  |
| Check overall performance of machine   |              | *             |                  |
| Check vac motor carbon brushes   |              |               | *                |

# FRAME ASSEMBLY

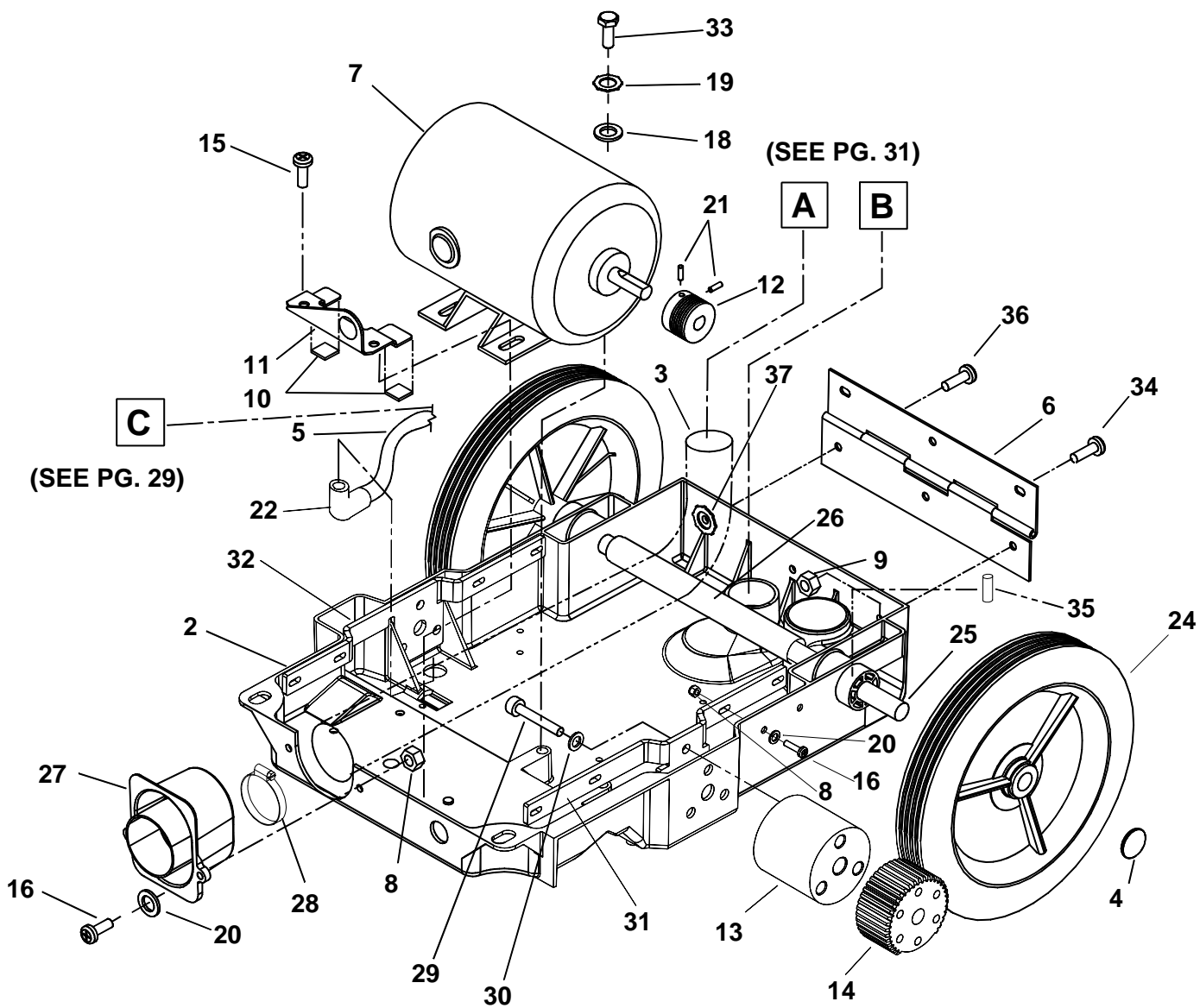

## FRAME ASSEMBLY

| REF | PART NO. | QTY | DESCRIPTION                    | SERIAL NO.<br>FROM | NOTES: |
|-----|----------|-----|--------------------------------|--------------------|--------|
| 1   | OPEN     |     |                                |                    |        |
| 2   | 34357    | 1   | FRAME, CLIPPER 12              |                    |        |
| 3   | 39528    | 1   | HOSE ASM, 1.5 BLK VAC X 15.5   |                    |        |
| 4   | 41236    | 2   | HUBCAP, 5/8" SHAFT             |                    |        |
| 5   | 41351    | 1   | HARNESS, MAIN, CLP/ADM         |                    |        |
| 6   | 41354    | 1   | HINGE, TANK TO FRAME           |                    |        |
| 7   | 53640    | 1   | MOTOR ASM, BRUSH CLP FAMILY    |                    |        |
| 8   | 57030    | 10  | NUT, 10-32 HEX NYLOCK          |                    |        |
| 9   | 57245    | 3   | NUT, 1/4-20 HEX NYLOCK SS      |                    |        |
| 10  | 99809    | 2   | FOAM TAPE, 1/8 THK X 3/4 1SDA  |                    |        |
| 11  | 62761    | 1   | PLATE, BRUSH MTR CLAMP         |                    |        |
| 12  | 64099    | 1   | PULLEY, 1.4 OD, 6GR, MICRO-V   |                    |        |
| 13  | 73949    | 2   | SPACER, HANDLE PIVOT           |                    |        |
| 14  | 36081    | 2   | GEAR, 40 TOOTH                 |                    |        |
| 15  | 70085    | 2   | SCR, 1/4-20 X 1/2 PPHMS SS     |                    |        |
| 16  | 70066    | 10  | SCR, 10-32 X 3/4 PPHMS         |                    |        |
| 17  | OPEN     |     |                                |                    |        |
| 18  | 87013    | 2   | WASHER, 1/4 ID X 5/8 OD SS     |                    |        |
| 19  | 87025    | 2   | WASHER, 1/4 LOCK EXT STAR SS   |                    |        |
| 20  | 87018    | 10  | WASHER, #10 X 9/16 OD          |                    |        |
| 21  | 70074    | 2   | SET SCR, 10-32 X 1/4 KCP       |                    |        |
| 22  | 73197    | 1   | STRAIN RELIEF, 90 DEGREE       |                    |        |
| 23  | OPEN     |     |                                |                    |        |
| 24  | 89114    | 2   | WHEEL, 1-5/16 X 9.625 DIA      |                    |        |
| 25  | 03107    | 1   | AXLE, 5/8 X 17.06L             |                    |        |
| 26  | 99667    | 10" | HEAT SHRINK, 3/4 ID UL/CSA     |                    |        |
| 27  | 73943    | 1   | SEAL, FRAME/TANK               |                    |        |
| 28  | 20041    | 1   | CLAMP, 2.0" WORM GEAR          |                    |        |
| 29  | 70671    | 6   | SCR, 5/16-18 X 3.5 SHCS PLATED |                    |        |
| 30  | 87083    | 6   | WASHER, 5/16 SPLIT LOCK PLTD   |                    |        |
| 31  | 140354   | 1   | BRKT, CLP HANDLE SUPPORT       |                    |        |
| 32  | 140355   | 1   | BRKT, CLP HANDLE SUPPORT LT    |                    |        |
| 33  | 70271    | 2   | SCR, 1/4-20 X 1/2 HHCS PLTD    |                    |        |
| 34  | 70057    | 2   | SCR, 1/4-20 X 1 PPHMS SS       |                    |        |
| 35  | 66052    | 1   | PIN, ROLL 1/8" X 1.0"L         |                    |        |
| 36  | 70697    | 1   | SCR, 1/4-20 X 1.25 PPHMS SS    |                    |        |
| 37  | 57105    | 3   | NUT, 1/4-20 HEX W/ STAR WASHER |                    |        |

# BRUSH ASSEMBLY

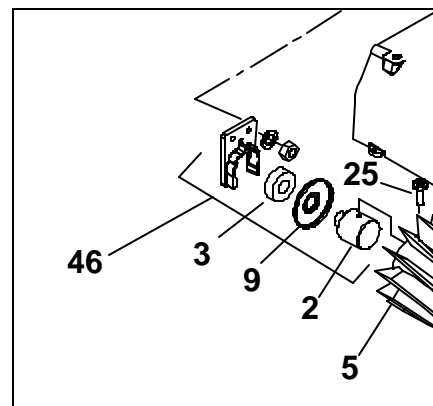
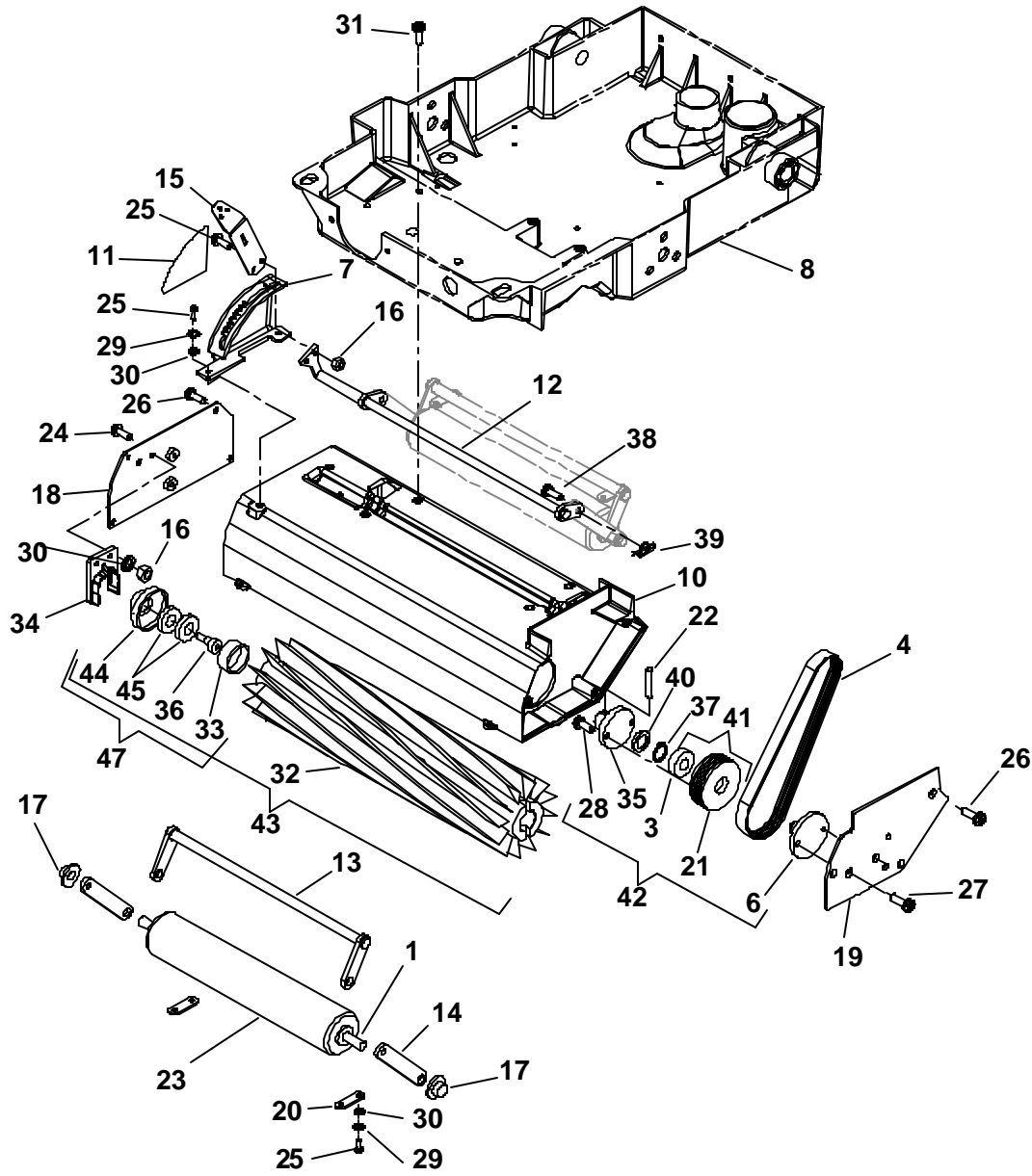



# BRUSH ASSEMBLY

| REF | PART NO. | QTY | DESCRIPTION                      | SERIAL NO.<br>FROM | NOTES: |
|-----|----------|-----|----------------------------------|--------------------|--------|
| 1   | 03110    | 1   | AXLE, ROLLER                     |                    |        |
| 2   | 04084    | 1   | ADAPTER, BRUSH BRG.              |                    |        |
| 3   | 09019    | 2   | BEARING, 1.125ODX.500IDX.375     |                    |        |
| 4   | 11045    | 1   | BELT, 180J6 MICRO-V              |                    |        |
| 5   | 12032    | 1   | BRUSH, 18L X 3.38OD              |                    |        |
| 6   | 140343   | 1   | BRKT, BRUSH PULLEY               |                    |        |
| 7   | 140351   | 1   | BRKT, BRUSH HEIGHT               |                    |        |
| 8   | 34357    | REF | FRAME, CLIPPER 12                |                    |        |
| 9   | 36192    | 2   | GUARD, THREAD                    |                    |        |
| 10  | 41346    | 1   | HOUSING, BRUSH, 18"              |                    |        |
| 11  | 50998    | 1   | LABEL, BRUSH HEIGHT              |                    |        |
| 12  | 51311    | 1   | LINKAGE, ASM, BRUSH HEIGHT       |                    |        |
| 13  | 51312    | 1   | LINKAGE ASM, ROLLER SUPPORT      |                    |        |
| 14  | 51314    | 2   | LINK, ROLLER, FRONT              |                    |        |
| 15  | 51317    | 1   | LEVER, HEIGHT ADJUSTMENT         |                    |        |
| 16  | 57030    | 4   | NUT, 10-32 HEX NYLOCK            |                    |        |
| 17  | 57271    | 2   | NUT, 3/8 DIA CAP, TYPE PUSH PLT  |                    |        |
| 18  | 62758    | 1   | PLATE, BRUSH HOUSING RH          |                    |        |
| 19  | 62759    | 1   | PLATE, BRUSH HOUSING LH          |                    |        |
| 20  | 62762    | 2   | PLATE, AXLE RETAINER             |                    |        |
| 21  | 64098    | 1   | PULLEY, 2.2 OD, 6GR, MICRO-V     |                    |        |
| 22  | 66192    | 1   | PIN, ROLL 1/4 X 1.25L            |                    |        |
| 23  | 67411    | 1   | ROLLER, 1.9 DIA X 10.5 LG        |                    |        |
| 24  | 70043    | 2   | SCR, 10-32 X 5/8 PFHMS           |                    |        |
| 25  | 70088    | 6   | SCR, 10-32 X 1/2 PPHMS SS DL     |                    |        |
| 26  | 70177    | 7   | SCR, 10-32 X 1/2 FHMS SS         |                    |        |
| 27  | 70232    | 2   | SCR, 10-32 X 3/8 FHMS SS         |                    |        |
| 28  | 70497    | 2   | SCR, #10-24 X 1/2 SHCS           |                    |        |
| 29  | 87016    | 4   | WASHER, #10 LOCK EXT STAR SS     |                    |        |
| 30  | 87018    | 6   | WASHER, #10 X 9/16 OD            |                    |        |
| 31  | 70675    | 4   | SCR, 1/4-20 X. 5/8 THMS PLTD NP  |                    |        |
| 32  | 12525    | 1   | BRUSH, 18L X 3.38 OD G2          | 1000090717         |        |
| 33  | 67467    | 1   | RING, TOLERANCE 7/8 ID X 1/2 W   | 1000090717         |        |
| 34  | 27805    | 1   | CLIP, BEARING                    |                    |        |
| 35  | 29157    | 1   | DRIVER, BRUSH                    |                    |        |
| 36  | 70737    | 1   | SHLDR BOLT, 3/8 OD X 3/8 L SS NP | 1000090717         |        |
| 37  | 67094    | 1   | RING, 1/2 EXT. SNAP              |                    |        |
| 38  | 66310    | 2   | PIN, CLEVIS 1/4 X 1/2 PLTD       |                    |        |
| 39  | 80604    | 2   | COTTER, 1/4" RING                |                    |        |
| 40  | 73966    | 1   | SPACER, .81ID X 1.06OD, ALUM     |                    |        |
| 41  | 64102    | 1   | PULLEY ASM, BRUSH                |                    |        |
| 42  | 29208    | 1   | DRIVER ASM, BRUSH                |                    |        |
| 43  | 12515    | 1   | BRUSH ASM, 18 IN                 |                    |        |
| 44  | 05158    | 1   | ADAPTER, BRUSH BRG. DIE CAST     | 1000090717         |        |
| 45  | 09137    | 2   | BEARING, R6 3/8 ID               | 1000090717         |        |
| 46  | 47383    | 1   | BRUSH BEARING ASM.               |                    |        |
| 47  | 47416    | REF | KIT,BRNG/ADPTR EXTRCTR           |                    |        |



# PUMP ASSEMBLY

| REF | PART NO. | QTY | DESCRIPTION                    | SERIAL NO.<br>FROM | NOTES:         |
|-----|----------|-----|--------------------------------|--------------------|----------------|
| 1   | 22072    | 1   | COUPLING, 1/4 ANCHOR W/1" HEX  |                    |                |
| 2   | 22090    | 2   | CONNECTOR, 1/8FPT X 1/4 TUBEQC |                    |                |
| 3   | 31072    | 1   | ELBOW, SWIVEL, 1/4MPTX1/4TUBE  |                    |                |
| 4   | 31074    | 1   | ELBOW, SWIVEL,3/8MPTX3/8TUBEQC |                    |                |
| 5   | 44067    | 2   | JET BODY, MINI PROMAX BODY     |                    |                |
| 6   | 44068    | 2   | JET, MINI PROMAX 9504          |                    |                |
| 7   | 57030    | 2   | NUT, 10-32 HEX NYLOCK          |                    |                |
| 8   | 65201    | 1   | PUMP ASM, 115V 100 PSI W/CONN  | 1000030022         |                |
| 9   | 66288    | 2   | PLUG, 9/16 OD BLK NYLON        |                    |                |
| 10  | 70386    | 2   | SCR, 10-32 X 1.0 PPHMS         |                    |                |
| 11  | 70011    | 2   | SCR, 1/4-20 X 5/8 HHCS SS      |                    |                |
| 12  | 34355    | 1   | FITTING,1/4 TUBE,"Y", QC       |                    |                |
| 13  | 78419    | 1   | TEE, 3/8 MPT X 3/8 TUBE, QC    |                    |                |
| 14  | 84160    | 1   | VALVE ASM,SOLENOID CLP FAMILY  |                    |                |
| 15  | 87191    | 2   | WASHER, 1/4"IDX1.0OD. FLAT SS  |                    |                |
| 16  | 87018    | 4   | WASHER, #10 X 9/16 OD          |                    |                |
| 17  | 87192    | 2   | WASHER, 7/16 X 3/4 X .19RUBBER |                    |                |
| 18  | 56014    | 1   | NIPPLE, 1/4 CLOSE              |                    |                |
| 19  | 56012    | 1   | NIPPLE, 1/4 FPT QD             |                    |                |
| 20  | 31076    | 2   | ELBOW, 1/4 MPT X 3/8 TUBE, QC  |                    |                |
| 21  | 70162    | 2   | SCR, 10-32 X 3/8 PPHMS SS      |                    |                |
| 22  | -        | -   | OPEN                           |                    |                |
| 23  | 880278   | 1   | WIRE, 22" GRN/18 76011 X 76011 |                    |                |
| 24  | 39529    | 1   | HOSE, 3/8 URETHANE X 29"       |                    |                |
| 25  | 39530    | 1   | HOSE, 3/8 NYLON X 6"           |                    |                |
| 26  | 39531    | 3   | HOSE, 1/4 URETHANE X 6"        |                    |                |
| 27  | 73963    | 1   | SCREEN, INTAKE                 |                    |                |
| 28  | 31022    | 1   | ELBOW, 1/8NPT STREET           |                    |                |
| 29  | 39551    | 1   | HOSE, 3/8 NYLON X 29"          |                    |                |
| 30  | 65183    | REF | PUMP ASM, 115V 100 PSI SHURFLO |                    | X-REF TO 47306 |

# VACUUM SHOE ASSEMBLY

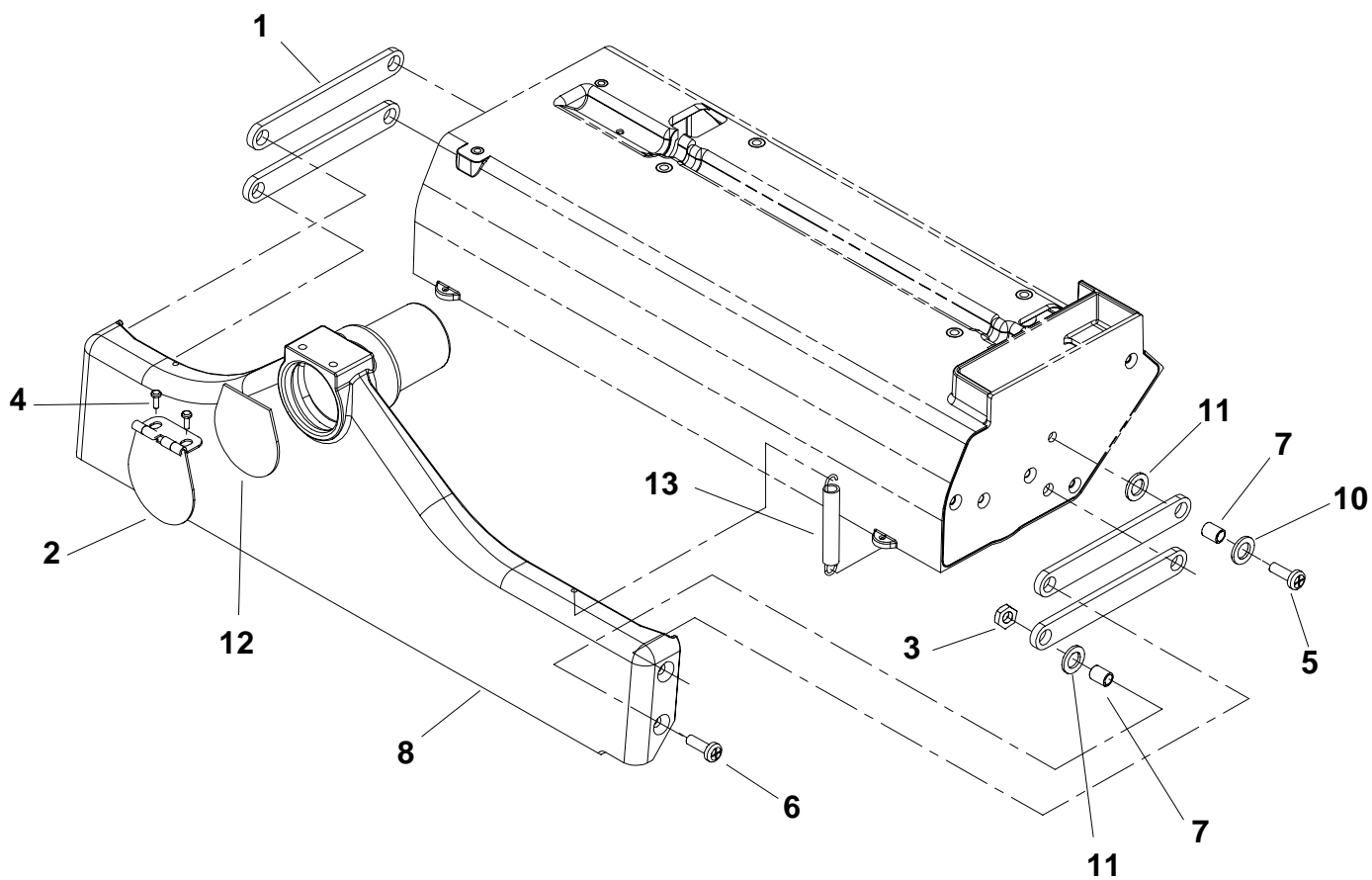

## VACUUM SHOE ASSEMBLY

| REF | PART NO. | QTY | DESCRIPTION                    | SERIAL NO.<br>FROM | NOTES: |
|-----|----------|-----|--------------------------------|--------------------|--------|
| 1   | 05016    | 4   | ARM, VAC SHOE PARALLEL         |                    |        |
| 2   | 27674    | 1   | COVER, ACCESSORY PORT          |                    |        |
| 3   | 57245    | 4   | NUT, 1/4-20 HEX NYLOCK SS      |                    |        |
| 4   | 70351    | 2   | SCR, 10-32 X 3/8 HHTR W/STAR   |                    |        |
| 5   | 70360    | 4   | SCR, 1/4-20 X.75 PPHMS PHIL    |                    |        |
| 6   | 70390    | 4   | SCR, 1/4-20 X 1 FHCS PLTD      |                    |        |
| 7   | 73958    | 8   | SPACER, 3/8ODX.058WX.2814,CRS  |                    |        |
| 8   | 85040    | 1   | VAC SHOE, 18"                  |                    |        |
| 9   | OPEN     |     |                                |                    |        |
| 10  | 87013    | 4   | WASHER, 1/4 ID X 5/8 OD SS     |                    |        |
| 11  | 87074    | 8   | WASHER, WAVE 3/8ID X3/4D X.125 |                    |        |
| 12  | 35171    | 1   | GASKET, ACCESSORY PORT         |                    |        |
| 13  | 73955    | 2   | SPRING, EXT .38D X2.75L X.055W |                    |        |

# CONTROL PANEL ASSEMBLY

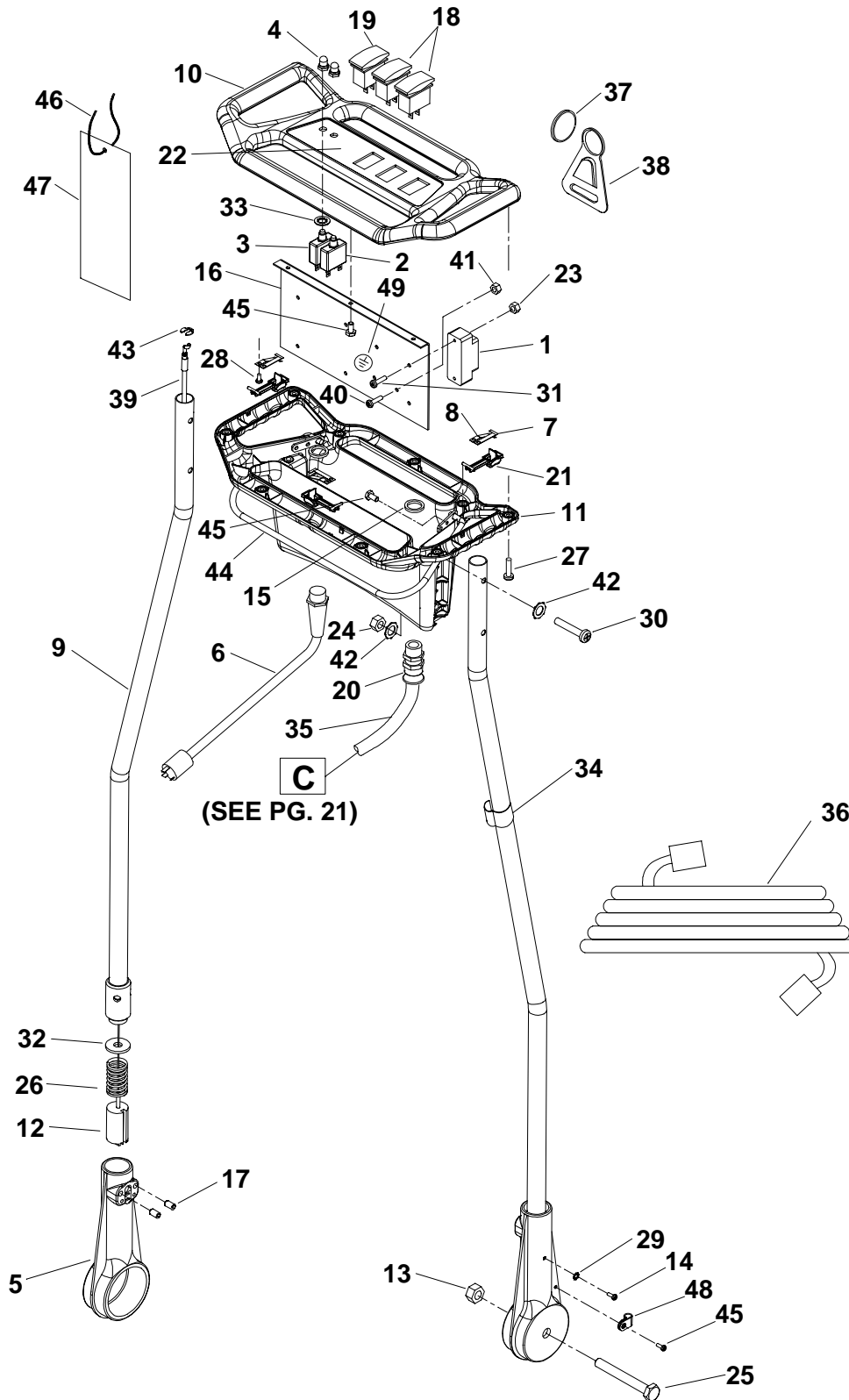

## CONTROL PANEL ASSEMBLY

| REF | PART NO. | QTY | DESCRIPTION                     | SERIAL NO.<br>FROM | NOTES: |
|-----|----------|-----|---------------------------------|--------------------|--------|
| 1   | 14020    | 1   | TERMINAL BLOCK, 115V (3-4-3)    |                    |        |
| 2   | 14700    | 1   | BREAKER, 15A 250VAC 50VDC       |                    |        |
| 3   | 14832    | 1   | BREAKER, 6A VDE CIRCUIT         |                    |        |
| 4   | 14942    | 2   | BOOT, 3/8 CIRCUIT BREAKER       |                    |        |
| 5   | 41181    | 2   | HOUSING, CLP HANDLE PIVOT       |                    |        |
| 6   | 23679    | 1   | CORD ASM, 14/3 X 22" YLW        |                    |        |
| 7   | 27823    | 3   | CONTACT, ELECTRICAL, FLAT       |                    |        |
| 8   | 27824    | 3   | CONTACT, ELECTRICAL, BENT       |                    |        |
| 9   | 38285    | 2   | HANDLE, CLP12 WELDED            |                    |        |
| 10  | 38286    | 1   | HANDLE, CONTROL PANEL FRONT     |                    |        |
| 11  | 38287    | 1   | HANDLE, CONTROL PANEL REAR      |                    |        |
| 12  | 51114    | 2   | LOCK, HANDLE POSITION           |                    |        |
| 13  | 57153    | 2   | NUT, 1/2-13HEXNYLOCK THIN PLTD  |                    |        |
| 14  | 70067    | 2   | SCR, 6-32 X 3/8 PPHMS           |                    |        |
| 15  | 57040    | 2   | NUT, 1/2 NPT CONDUIT            |                    |        |
| 16  | 62766    | 1   | PLATE, CONTROL PANEL, CLP/ADM   |                    |        |
| 17  | 70330    | 4   | SET SCR, 5/16-18 X 1/2 CONE PT  |                    |        |
| 18  | 72130    | 2   | SWITCH, SPST 2-POSITION ROCKER  |                    |        |
| 19  | 72162    | 1   | SWITCH, DPDT3-POSITION ROCKER   |                    |        |
| 20  | 73505    | 1   | STRAIN RELIEF, 1/2 NPT TRUMPET  |                    |        |
| 21  | 78418    | 3   | TRIGGER, SWITCH                 |                    |        |
| 22  | 50996    | 1   | LABEL, CONTROL PANEL, CLP/ADM   |                    |        |
| 23  | 57116    | 2   | NUT, 6-32 W/STAR WASHER PLTD    |                    |        |
| 24  | 57245    | 4   | NUT, 1/4-20 HEX NYLOCK SS       |                    |        |
| 25  | 70672    | 2   | SCR, 1/2-13 X 4.75HHCS GR5 PLT  |                    |        |
| 26  | 73307    | 2   | SPRING, COMP .88D X1.4L X.100W  |                    |        |
| 27  | 70406    | 9   | SCR, #10 X 3/4 PPHST TYPE B     |                    |        |
| 28  | 70127    | 6   | SCR, 6-32 X 1/4 PPHMS SS        |                    |        |
| 29  | 87026    | 2   | WASHER, #6 LOCK EXT STAR SS     |                    |        |
| 30  | 70105    | 4   | SCR, 1/4-20 X 1.75 PPHMS SS     |                    |        |
| 31  | 70235    | 2   | SCR, 6-32 X 1.0 PH BLK NYLON    |                    |        |
| 32  | 87086    | 2   | WASHER, M10 X 30 PLTD           |                    |        |
| 33  | 87100    | 2   | WASHER, 3/8 ID INT.LOCK THIN    |                    |        |
| 34  | 27371    | 2   | CLIP, POWER CORD                |                    |        |
| 35  | 41351    | REF | HARNESS, MAIN CLP/ADM           |                    |        |
| 36  | 23086    | 1   | CORD SET, 14/3 SJTW-A X 50' YLW |                    |        |
| 37  | 67147    | 1   | RING, 2" DIA SPLIT              |                    |        |
| 38  | 73169    | 1   | STRAIN RELIEF, CORD HOOK        |                    |        |
| 39  | 27817    | 2   | CABLE, .06 X 40, 0707, SS       |                    |        |
| 40  | 70386    | 1   | SCR, 10-32 X 1" PPHMS           |                    |        |
| 41  | 57104    | 3   | NUT, 10-32 W/STAR WASHER PLTD   |                    |        |
| 42  | 87025    | 6   | WASHER, 1/4 LOCK EXT STAR SS    |                    |        |
| 43  | 67381    | 2   | RING, 1/4 KLIP                  |                    |        |
| 44  | 51319    | 1   | LEVER ASM, CLP HANDLE ADJ       |                    |        |
| 45  | 70351    | 5   | SCR, 10-32 X 3/8 HHTR W/STAR    |                    |        |
| 46  | 27417    | 1   | CORD, 99807 1/8 X 12"           |                    |        |
| 47  | 500018   | 1   | CARD, INSTRUCTION CLP12         |                    |        |
| 48  | 20035    | 1   | CLAMP, 7/16 DIA NYLON UL        |                    |        |
| 49  | 50279    | 1   | LABEL, GROUND SYMBOL            |                    |        |

# SOLUTION TANK ASSEMBLY

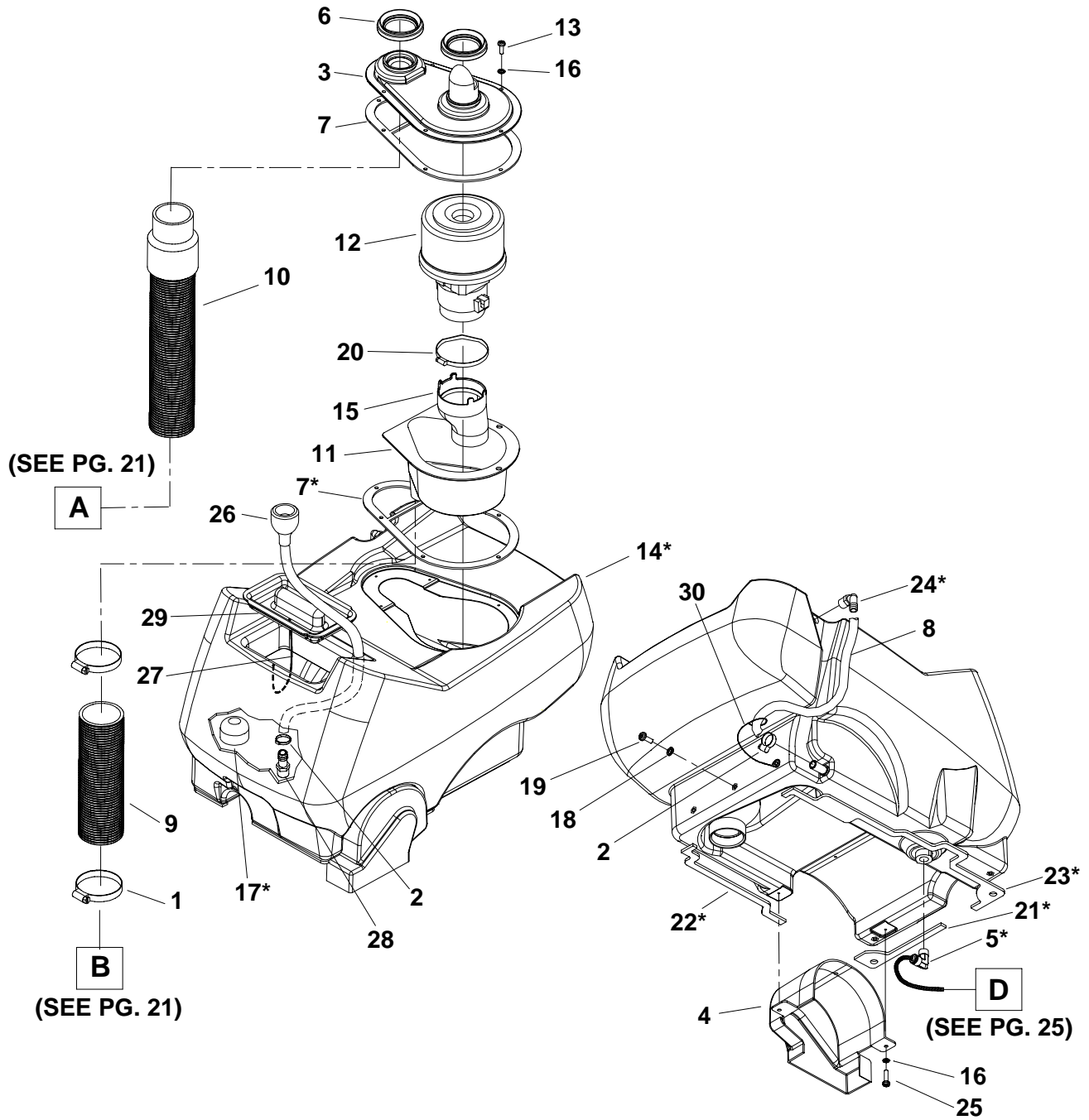



## SOLUTION TANK ASSEMBLY

| REF | PART NO. | QTY | DESCRIPTION                        | SERIAL NO.<br>FROM | NOTES:         |
|-----|----------|-----|------------------------------------|--------------------|----------------|
| 1   | 20041    | 2   | CLAMP, 2.0" WORM GEAR              |                    |                |
| 2   | 20042    | 2   | CLAMP, 3/8 HOSE (D-SLOT)           |                    |                |
| 3   | 27809    | 1   | COVER, VAC MOTOR                   |                    |                |
| 4   | 27810    | 1   | COVER, BELT                        |                    |                |
| 5   | 31081    | 1   | ELBOW, 3/8 MPT X 3/8 TUBE, PLASTIC |                    |                |
| 6   | 35175    | 2   | GASKET, TANK TO VAC COVER          |                    |                |
| 7   | 35231    | 2   | GASKET, VAC COVER (CLP FAMILY)     |                    |                |
| 8   | 39526    | 1   | HOSE, 1/2 CLEAR X 12               |                    |                |
| 9   | 39536    | 1   | HOSE, 1.5 BLK VAC X 5.0            |                    |                |
| 10  | 39528    | REF | HOSE ASM, 1.5 BLK VAC X 15.5       |                    |                |
| 11  | 41348    | 1   | HOUSING, VAC MOTOR                 |                    |                |
| 12  | 53789    | 1   | VAC MOTOR ASM, CLP FAMILY          |                    |                |
| 13  | 70525    | 6   | SCR, #10 X 1.0 PPHST TYPE B        |                    |                |
| 14  | 75261    | 1   | TANK, CLP SOLUTION                 |                    |                |
| 15  | 85038    | 1   | VENT, COOLING AIR LARGE            |                    |                |
| 16  | 87018    | 9   | WASHER, #10 X 9/16 OD              |                    |                |
| 17  | 73864    | 1   | STRAINER, 3/8 IN. NPT 60 MESH      |                    |                |
| 18  | 87013    | 3   | WASHER, 1/4 ID X 5/8 OD SS         |                    |                |
| 19  | 70085    | 3   | SCR, 1/4-20 X 1/2 PPHMS SS DL      |                    |                |
| 20  | 20092    | 1   | CLAMP, 3.5" WORM GEAR              |                    |                |
| 21  | 35236    | 1   | GASKET, TANK, L-F                  |                    |                |
| 22  | 35237    | 1   | GASKET, TANK, L-R                  |                    |                |
| 23  | 35238    | 1   | GASKET, TANK, RH                   |                    |                |
| 24  | 40027    | 1   | HOSEBARB, 3/8MPTX1/2 90D DL        |                    |                |
| 25  | 70114    | 3   | SCR, #10 X 3/4 PPHST TYPE B        |                    |                |
| 26  | 02130    | 1   | HOSE ASSY- FILL HOSE               |                    |                |
| 27  | 27417    | 1   | CORD, 99807 1/8 X 12"              |                    |                |
| 28  | 40023    | 1   | HOSEBARB, 1/2MPT X 3/8 DL          |                    |                |
| 29  | 27827    | 1   | COVER, CLP SOLUTION                |                    |                |
| 30  | 51321    | 1   | LANYARD, .06 X 2.88                |                    |                |
| 31  | 75278    | 1   | TANK ASM, SOLUTION CLP12           |                    | ITEMS INCLUDED |

# RECOVERY TANK ASSEMBLY

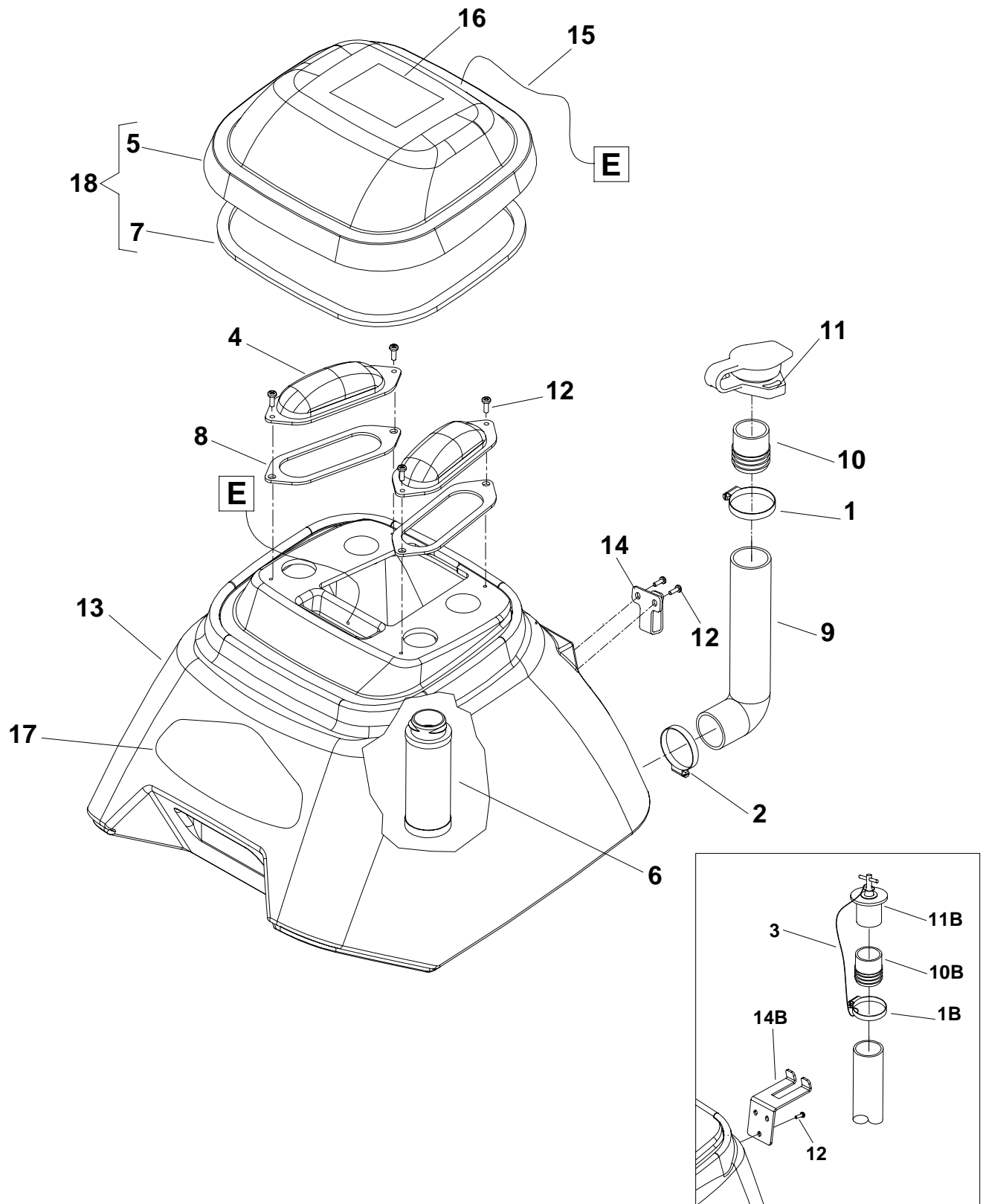

## RECOVERY TANK ASSEMBLY

| REF | PART NO. | QTY | DESCRIPTION                  | SERIAL NO.<br>FROM | NOTES: |
|-----|----------|-----|------------------------------|--------------------|--------|
| 1A  | 20064    | 1   | CLAMP, 2.0" WORM GEAR X .312 | 1000083387         |        |
| 1B  | 20002    | 1   | CLAMP, 2.0" NYLON RATCHET    |                    |        |
| 2   | 20041    | 1   | CLAMP, 2.0" WORM GEAR        |                    |        |
| 3   | 27670    | 1   | CORD, DRAIN PLUG             |                    |        |
| 4   | 27816    | 2   | COVER, REC. TANK             |                    |        |
| 5   | 28060    | 1   | DOME, CLP FAMILY             |                    |        |
| 6   | 34351    | 1   | FLOAT SHUT-OFF               |                    |        |
| 7   | 35230    | 1   | GASKET, DOME                 |                    |        |
| 8   | 35232    | 2   | GASKET, PORT COVER           |                    |        |
| 9   | 39353    | 1   | HOSE, 1.5 X 12.0 DRAIN       |                    |        |
| 10A | 41391    | 1   | HOSE, INSERT                 | 1000083387         |        |
| 10B | 40019    | 1   | HOSEBARB, 1.50 DOUBLE MCHD   |                    |        |
| 11A | 41390    | 1   | HOSE, CAP                    | 1000083387         |        |
| 11B | 66227    | 1   | PLUG, DRAIN HOSE             |                    |        |
| 12  | 70114    | 6   | SCR, #10 X 3/4 PPHST TYPE B  |                    |        |
| 13  | 75262    | 1   | TANK, CLP RECOVERY           |                    |        |
| 14A | 140408   | 1   | BRKT, HOSE HOOK              | 1000083387         |        |
| 14B | 140133   | 1   | BRKT, RECOVERY HOSE MTG      |                    |        |
| 15  | 27417    | 1   | CORD, 99807 1/8 X 12"        |                    |        |
| 16  | 500009   | 1   | LABEL, WARNING               |                    |        |
| 17  | 50993    | 1   | LABEL, CLIPPER MAIN          |                    |        |
| 18  | 28061    | 1   | DOME ASM, CLP FAM            |                    |        |

## **SUGGESTED SPARE PARTS**

| <b>SUGGESTED SPARE PARTS</b>   |                    |             |
|--------------------------------|--------------------|-------------|
| <b>DESCRIPTION</b>             | <b>PART NUMBER</b> | <b>PAGE</b> |
| BRUSH, 18L X 3.38OD            | 12032              | 23          |
| BELT, 180J6 MICRO-V            | 11045              | 23          |
| BEARING, 1.125ODX.500IDX.375   | 09019              | 23          |
| JET BODY, MINI PROMAX BODY     | 44067              | 25          |
| JET, MINI PROMAX 9504          | 44068              | 25          |
| PUMP ASM, CLP/ADM              | 65183              | 25          |
| VALVE ASM, SOLENOID CLP FAMILY | 84160              | 25          |
| GASKET, ACCESSORY PORT         | 35171              | 27          |
| BREAKER, 15A 250VAC 50VDC      | 14700              | 29          |
| BREAKER, 6A VDE CIRCUIT        | 14832              | 29          |
| SWITCH, SPST 2-POSITION ROCKER | 72130              | 29          |
| SWITCH, DPDT3-POSITION ROCKER  | 72162              | 29          |
| VAC MOTOR ASM, CLP FAMILY      | 53789              | 31          |
| STRAINER, 3/8 IN. NPT 60 MESH  | 73864              | 31          |
| DOME ASM, CLP FAMILY           | 28061              | 33          |
| FLOAT SHUT-OFF                 | 34351              | 33          |
| PLUG, DRAIN HOSE               | 66227              | 33          |

### **NOTES:**



# WINDSOR INDUSTRIES

## New Machine Warranty

### Limited Warranty

Windsor Industries, Inc. warrants new machines against defects in material and workmanship under normal use and service to the original purchaser. Any statutory implied warranties, including any warranty of merchantability or fitness for a particular purpose, are expressly limited to the duration of this written warranty. Windsor will not be liable for any other damages, including but not limited to indirect or special consequential damages arising out of or in connection with the furnishing, performance, use or inability to use the machine. This remedy shall be the exclusive remedy of the buyer. The warranty period is subject to the conditions stated below.

### 6 / 3 / 1 Warranty: 6 Years Polyethylene (PE) Housings, 3 Years Parts, and 1 Year Service Labor

Subject to conditions outlined below, Windsor Industries warrants rotationally molded PE housings and parts on all of its machines to be free from defects in material and workmanship, under normal use and service for six (6) years to the original owner.

Under this warranty we guarantee the performance of non-polyethylene parts and components to be free from defects and for up to three (3) years to the original end user. Parts replaced or repaired under this warranty are guaranteed for the remainder of the original warranty period. (See table below)

Service labor charges are covered for up to one (1) year from the date of purchase through authorized Windsor service provider. No travel coverage is extended for cord-electric models. See table below for each general product model warranty coverage.

| Product                           | PE Housing & Parts | Non- PE Parts | Service Labor | Travel   |
|-----------------------------------|--------------------|---------------|---------------|----------|
| Rider Scrubbers                   | 6 years            | 3 years       | 1 years       | 6 Months |
| Rider Sweepers                    | 6 years            | 1 year        | 1 years       | 6 Months |
| Walk Behind Scrubbers             | 6 years            | 3 years       | 1 years       | 6 Months |
| Walk Behind Sweepers              | 6 years            | 1 year        | 1 years       | 6 Months |
| Extractors                        | 6 years            | 3 years       | 1 years       | -        |
| Polishers / Elec. Burnishers / GH | 6 years            | 3 years       | 1 years       | -        |
| Wide Areas Vacuums                | 6 years            | 3 years       | 1 years       | -        |
| VacPak Vacuums                    | 6 years            | 1 year        | 1 year        | -        |
| Air Movers / Dri-matic / TITAN™   | 1 year             | 1 year        | 1 year        | -        |
| Propane Burnishers / Strippers    | -                  | 2 year        | 1 year        | -        |
| Tracer/Flex Sweepers/Scrubbers    | 6 years            | 2 year        | 6 months      | 90 days  |

|             |  |                          |
|-------------|--|--------------------------|
| VERSAMATIC® | Brush motor, Vacuum motor, Belts – 3 years | All other parts – 1 year |
| SENSOR®     | Vacuum motor, Belts – 2 years              | All other parts – 1 year |

### Product exceptions and Exclusions:

- Extractor brush motors, pump motors, **ALL** PC boards and electronics, **ALL** Vacuum motors (other than VERSAMATIC® and SENSOR®), **ALL** pumps, and FLEXSOL™ diaphragms carry a one (1) year parts and service labor warranty.
- The Onan® engines have three (3) year manufacturer’s warranty. The Honda® and Kawasaki® engines have two (2) year manufacturer’s warranty. **NOTE:** The engine warranty is administered through the engine manufacturer and must be repaired at an authorized service center.

Normal wear items and accessories including, but not limited to, belts, brushes, capacitors, carbon brushes, casters, clutches, cords, filters, finishes, gaskets, hoses, light bulbs, rectifiers, switches, squeegees, bearings, pulleys, relays, actuating cables, wheels, tires, propane tanks, and batteries will be warranted for manufacturing defects for 90-days from the purchase date.

The warranty commences on the purchase date by the original end user from an authorized Windsor agent, subject to proof of purchase. The Machine Registration Card must be completed and returned immediately at the time of purchase. If proof of purchase cannot be identified, the warranty start date is 90 days after the date of sale to an authorized Windsor distributor. Parts replaced or repaired under warranty are guaranteed for the remainder of the original warranty period.



## WINDSOR INDUSTRIES New Machine Warranty

---

### **90 Day Warranty Extension Available**

Upon receipt of the Machine Registration Card, Windsor will extend by 90 days, from the date of purchase, all items included under the one-year provision. This applies only to one-year items and does not include 90-day wear items.

### **This Warranty Shall Not Apply To:**

1. Any product that has been subject to abuse, misuse, neglect or unauthorized alteration (including the use of incompatible or corrosive chemicals or overloading of capacity).
2. Products that have experienced shipping or freight damage.
3. Repairs necessary to correct any failure due to improper pre-delivery service and inspection by the selling dealer.
4. Excessive time for cleaning units in preparation for repair.
5. Any repairs resulting from poor initial service work or improper diagnosis.
6. Tune-up parts such as plugs, plug wires and condensers.
7. Any design alterations performed by an organization not authorized or specified by Windsor.
8. Battery and charger warranties are handled directly with the manufacturer (Trojan® batteries and Lester® chargers).
9. High-pressure washing.
10. Electrical components exposed to moisture.

If difficulty develops during the warranty period, contact the authorized Windsor agent from whom the product was purchased. Windsor Industries, Inc. may elect to require the return of components to validate a claim. Any defective part to be returned must be shipped freight prepaid to an authorized Windsor Distributor/Service Center or to the Windsor factory.

### **Use Of Parts Not Approved By Windsor Industries, Inc. Will Void All Warranties**

This warranty is valid only for all products sold after July 1, 1995. A product sold before that date shall be covered by the limited warranty in effect at the date of sale to the original purchaser.