

# PS 16

---

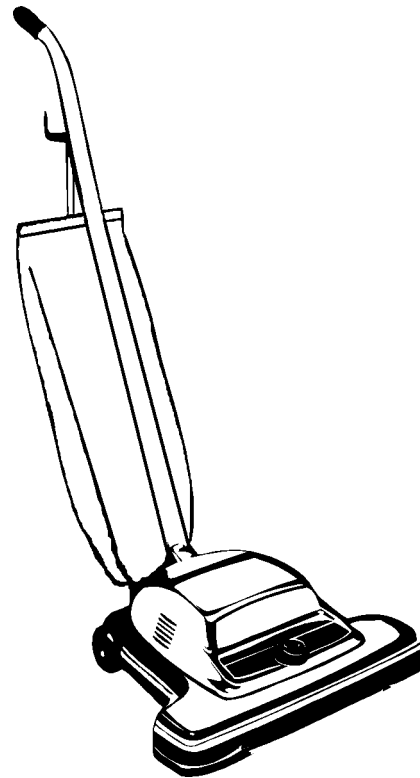

---

## **PARTS LIST**

**Euroclean MODEL 56649032**

<b>DESCRIPTION</b>	<b>PAGE</b>
BASE ASSEMBLY .....	2-3
AXLE / BRUSH / BUMPER ASSEMBLIES .....	4-5
VAC MOTOR ASSEMBLY .....	6-7
HANDLE ASSEMBLY .....	8-9
BAG ASSEMBLY / WIRING DIAGRAM .....	10-11

#### WHEN ORDERING PARTS

- \* Use the 8 digit numbers from the "Ref. No." columns in this parts list.
- \* Specify the model and serial number of the machine.
- \* Use the space below to record the model and serial number for future reference.

Model \_\_\_\_\_ Serial No. \_\_\_\_\_

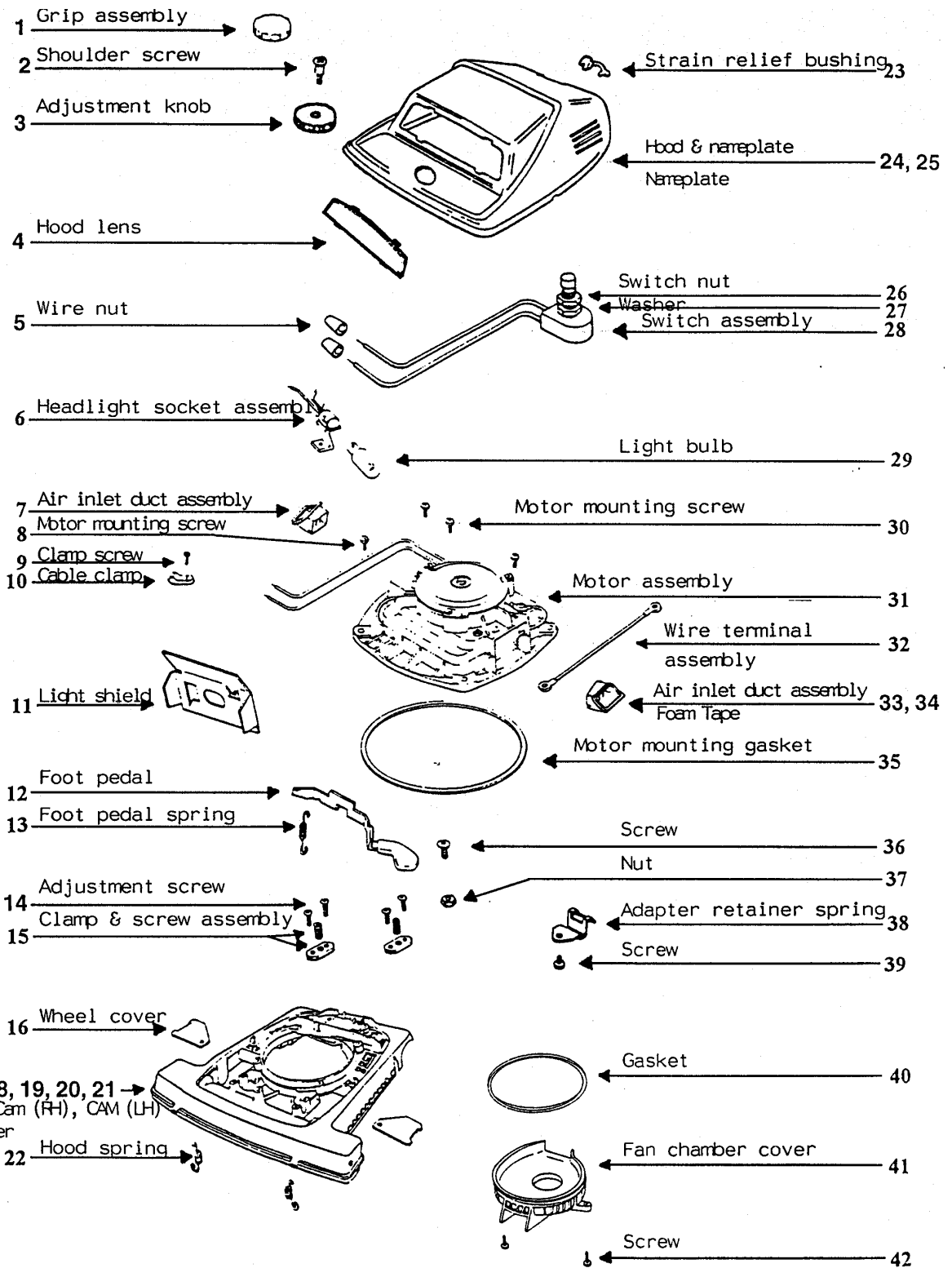

Item	Ref. No.	Qty	Description
1	56649447		Grip Assembly
2	56703420		Shoulder Screw (10 pack)
3	56649341		Adjustment Knob
4	56630265		Hood Lens
5	56649604		Wire Nut
6	56630680		Headlight Socket Assy
7	56630950		Air Inlet Duct Assy (RH) <b>(includes #34)</b>
8	56649536		Motor Mtg Screw (10 pack)
9	56649533		Clamp Screw (10 pack)
	56703625		Nut (10 pack)
10	56649528		Cable Clamp (5 pack)
11	56649412		Light Shield
12	56630395		Foot Pedal
13	56703430		Foot Pedal Spring (5 pack)
14	56703431		Adjustment Screw (10 pack)
15	56703432		Clamp & Screw Assy (6 pack)
16	56630606		Wheel Cover
17	56649541		Base Assy <b>(includes #18-21)</b>
18	56630399		Cam (RH)
19	56630400		Cam (LH)
20	56703451		Rivet Cam (10 pack)
21	56703452		Washer (10 pack)
22	56649524		Hood Spring (10 pack)
23	56703539		Strain Relief Bushing (10 pack)
24	56649602		Hood & Nameplate <b>(includes #25)</b>
25	56649451		Nameplate
26	56630917		Switch Nut
27	56649522		Washer (10 pack)
28	56649433		Switch Assy
29	56630722		Lightbulb
30	56703431		Motor Mtg Screw (10 pack)
31	56703589		Motor Assy
32	56630914		Wire Term Assy
33	56630949		Air Inlet Duct Assy (LH) <b>(includes #34)</b>
34	56630809		Foam Tape
35	56649652		Motor Mtg Gasket
36	56649533		Screw (10 pack)
37	56703625		Nut (10 pack)
38	56630668		Adapter Retainer Spring
39	56703431		Screw (10 pack)
40	56649652		Gasket
41	56630333		Fan Chamber Cover
42	56703431		Screw (10 pack)

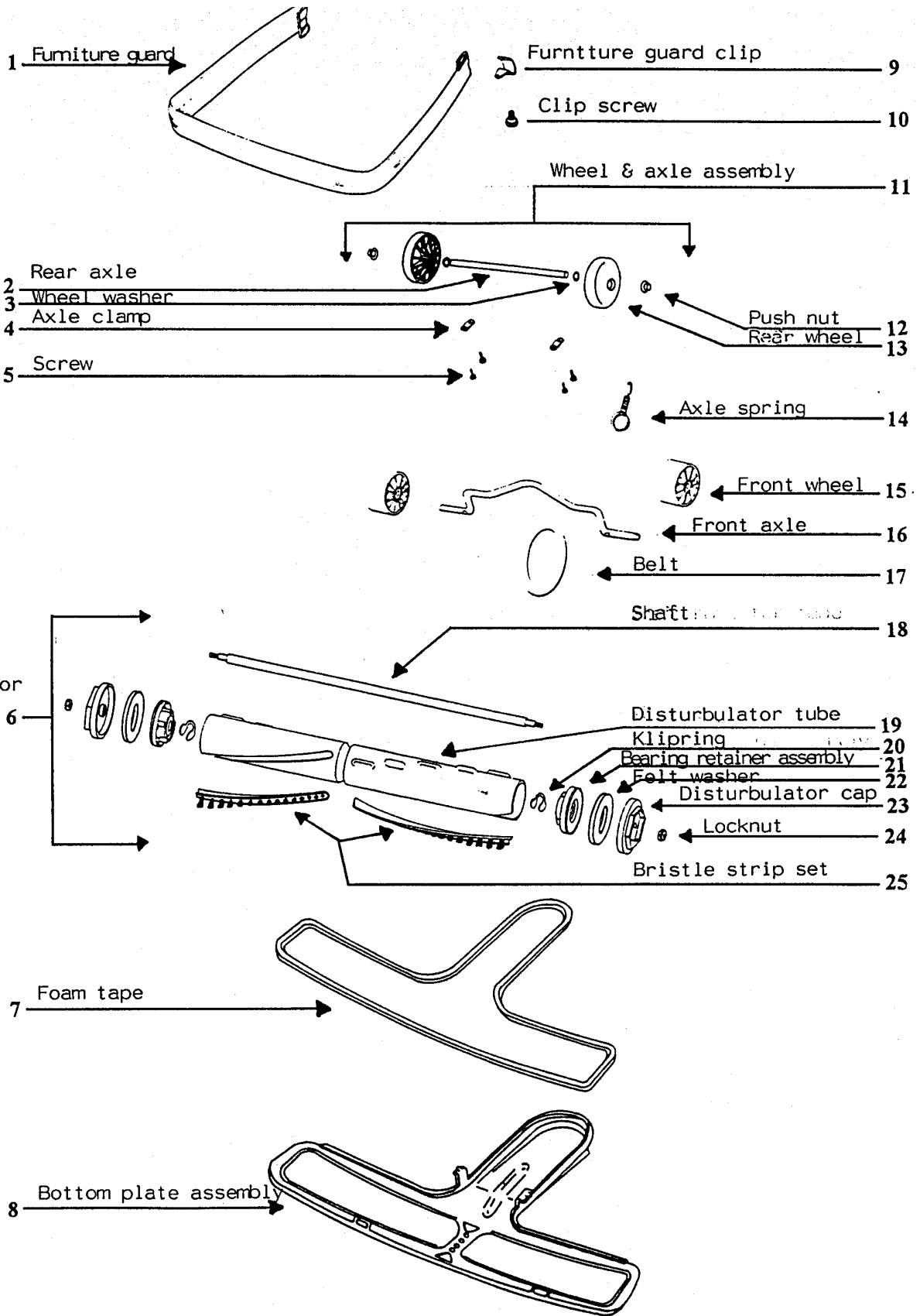

Item	Ref. No.	Qty	Description
1	56649421		Furniture Guard
2	56630671		Rear Axle
3	56649523		Wheel Washer (10 pack)
4	56703823		Axle Clamp (10 pack)
5	56703447		Screw (10 pack)
6	56649537		Disturbulator Assy ( <b>includes #18-25</b> )
7	56649479		Foam Tape
8	56630451		Bottom Plate Assy ( <b>includes #7</b> )
9	56630447		Furniture Guard Clip
10	56649535		Clip Screw (10 pack)
11	60160		Wheel & Axle Assy ( <b>includes #2,3,12-13</b> )
12	56649525		Push Nut
13	56630500		Rear Wheel
14	56703467		Axle Spring (6 pack)
15	56630592		Front Wheel
16	56630597		Front Axle
17	56649653		Belt
18	56649413		Shaft
19	56630223		Disturbulator Tube
20	56703460		Clipping (10 pack)
21	56649550		Bearing Retainer Assy (2 pack)
22	56630865		Felt Washer
23	56630486		Disturbulator Cap
24	56703458		Locknut (10 pack)
25	56649513		Bristle Strip Set
*	56630488		Disturbulator Cap Cover

\* = Not Shown

1 Motor assembly complete

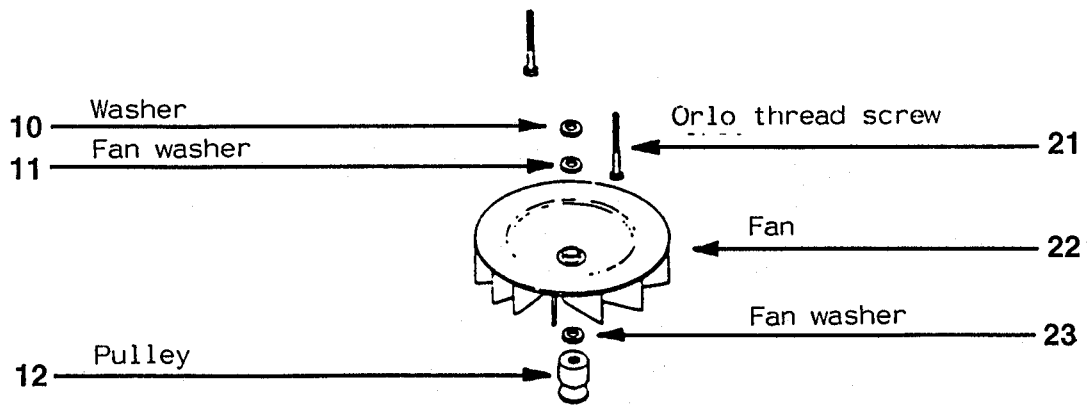
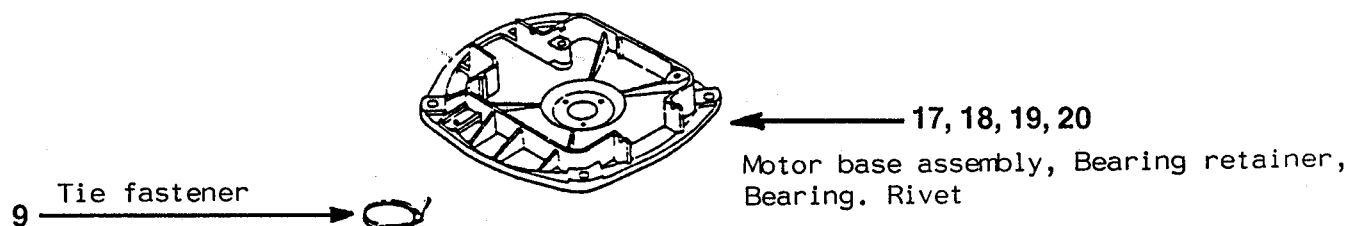
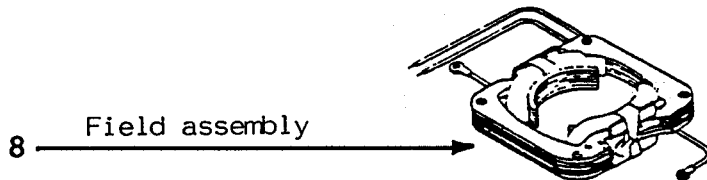
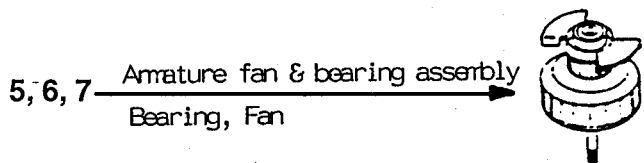
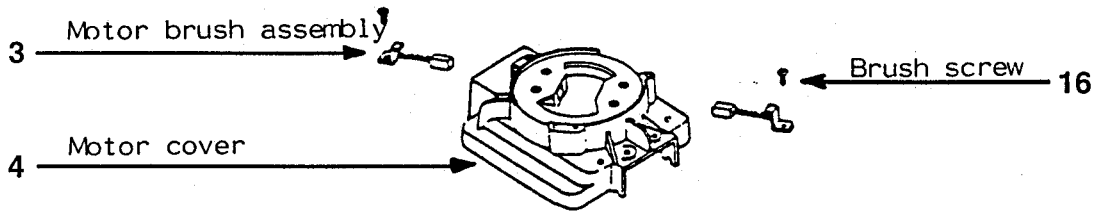
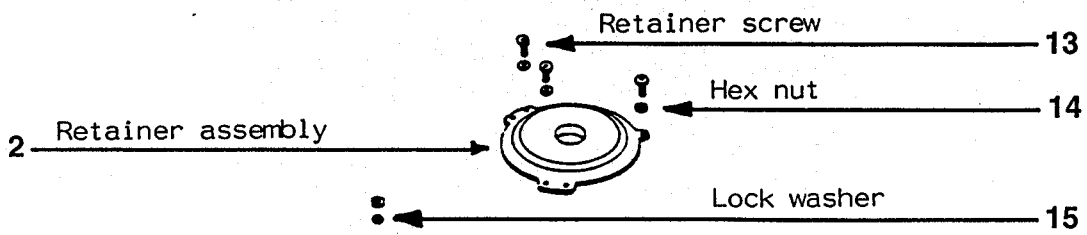

Item	Ref. No.	Qty	Description
1	56703589		Motor Assy Complete
2	56630375		Retainer Assy
3	56649651		Motor Brush Assy
4	56703603		Motor Cover
5	56630901		Armature Fan & Bearing Assy (includes #6, 7)
6	56649519		Bearing (5 pack)
7	56630560		Fan
8	56630895		Field Assy
9	56649480		Tie Fastener
10	56703485		Washer (10 pack)
11	56703486		Fan Washer (10 pack)
12	56630665		Pulley
13	56649527		Retainer Screw (10 pack)
14	56703625		Hex Nut (10 pack)
15	56703380		Lock Washer (10 pack)
16	56703392		Brush Screw
17	56703611		Motor Base Assy (includes #18-20)
18	56649552		Bearing Retainer
19	56649518		Bearing
20	56703484		Rivet (10 pack)
21	56703615		Orlo Thread Screw
22	56630273		Fan
23	56703486		Fan Washer (10 pack)



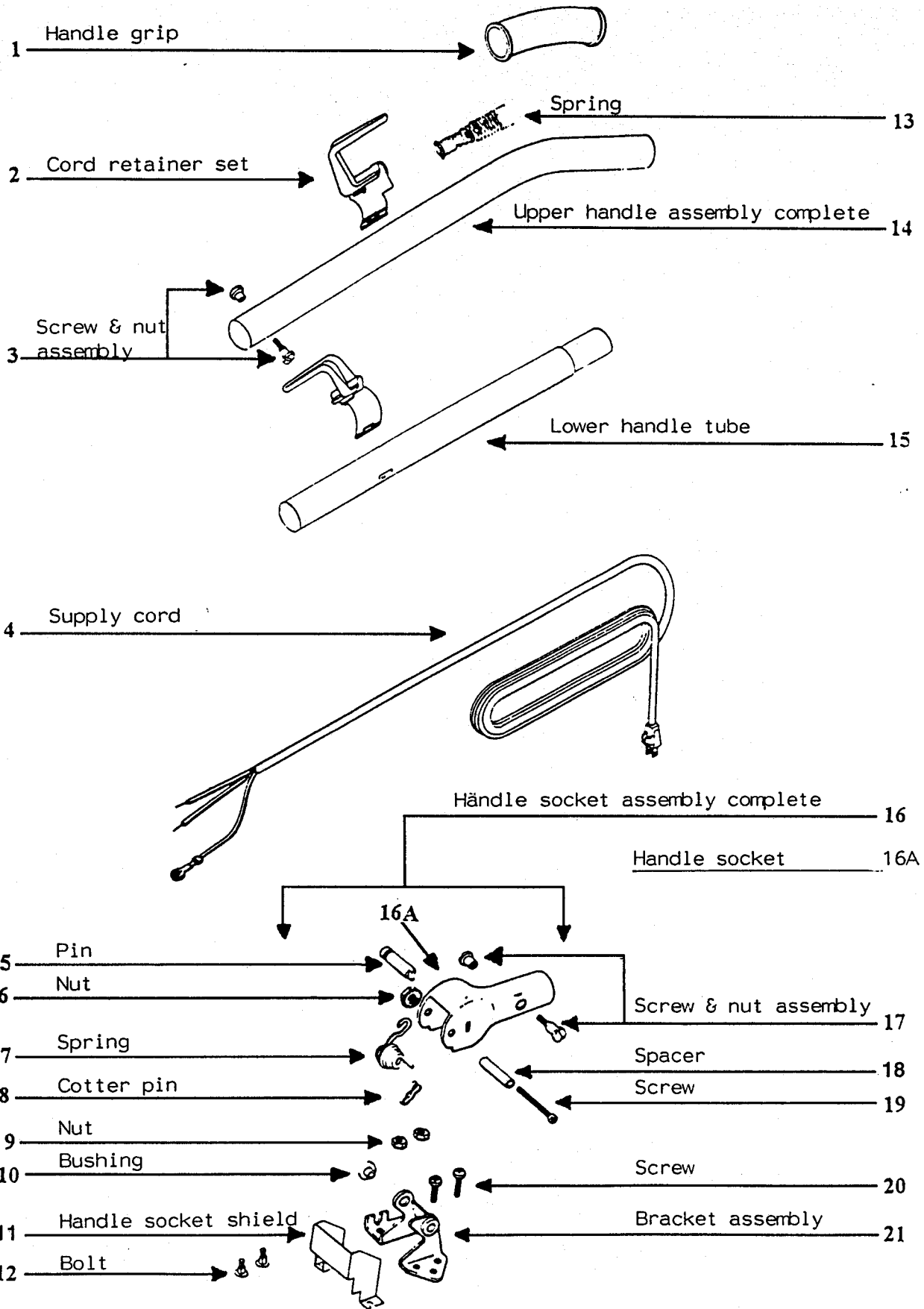

Item	Ref. No.	Qty	Description
1	56649430		Handle Grip
2	56703490		Cord Retainer Set
3	56703492		Screw & Nut Assy (6 pack)
4	56703495		Supply Cord
5	56630725		Pin
6	56703625		Nut (10 pack)
7	56649436		Spring
8	56649534		Cotter Pin (10 pack)
9	56703497		Nut (10 pack)
10	56649520		Bushing (5 pack)
11	56630623		Handle Socket Shield
12	56100032		Bolt (10 pack)
13	56703356		Spring
14	56703491		Upper Handle Assy Complete <b>(includes #1)</b>
15	56630268		Lower Handle Tube
16	56649435		Handle Socket Assy Complete <b>(includes #5-8, 16A, 18-19, 21)</b>
16A	56630408		Handle Socket
17	56703492		Screw & Nut Assy (6 pack)
18	56649521		Spacer (5 pack)
19	56649532		Screw (10 pack)
20	56649536		Screw (10 pack)
21	56649434		Bracket Assy

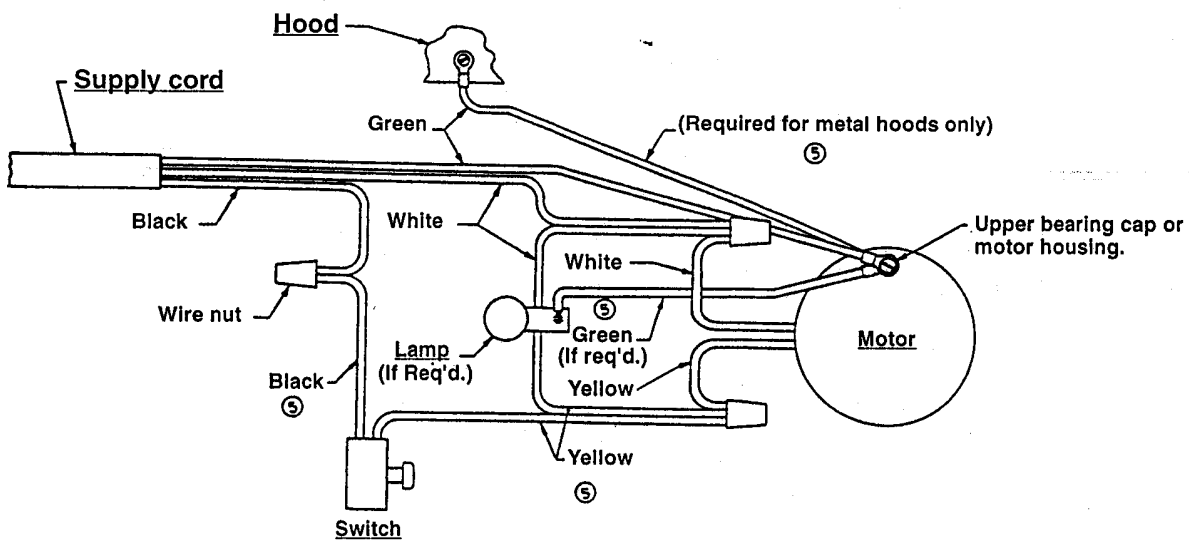
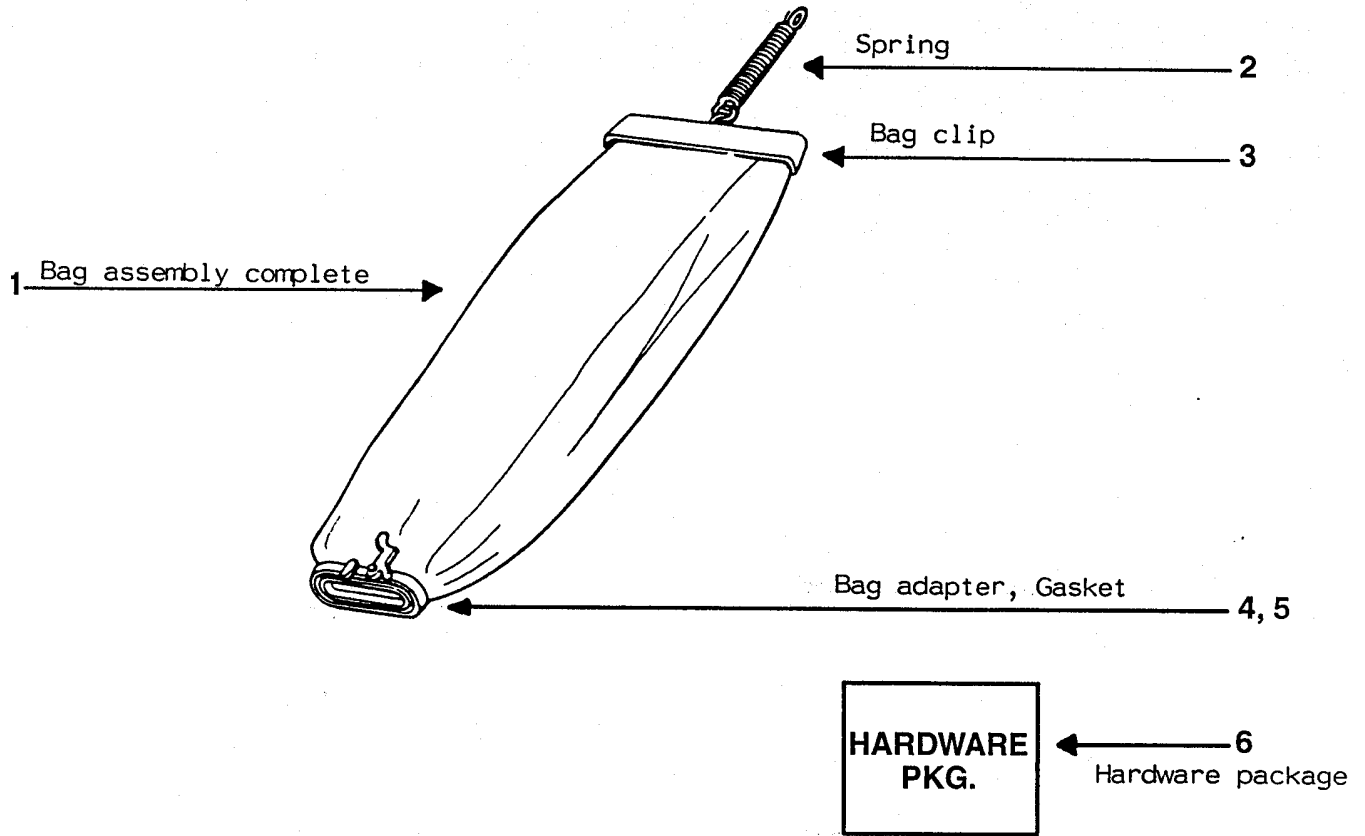

<b>Item</b>	<b>Ref. No.</b>	<b>Qty</b>	<b>Description</b>
1	56703511		Bag Assy Complete
2	56630761		Spring
3	56649424		Bag Clip
4	56630415		Bag Adapter
5	56630773		Gasket
6	56649482		Hardware Package
**	141045100		Zipper Bag
**	141216900		Paper Bags (9 pack)

\*\* = Optional (not included)



**KENT/  
Euroclean**  
*Working For A Cleaner World*

Kent/Euroclean  
14600 21st Avenue North  
Plymouth, MN, 55447-3408  
[www.eurocleanusa.com](http://www.eurocleanusa.com)  
Phone: 800-334-1083  
Fax: 866-261-4779