

Gold 18 18" Two Motor Upright Vacuum

Parts Schematic

Item #85801

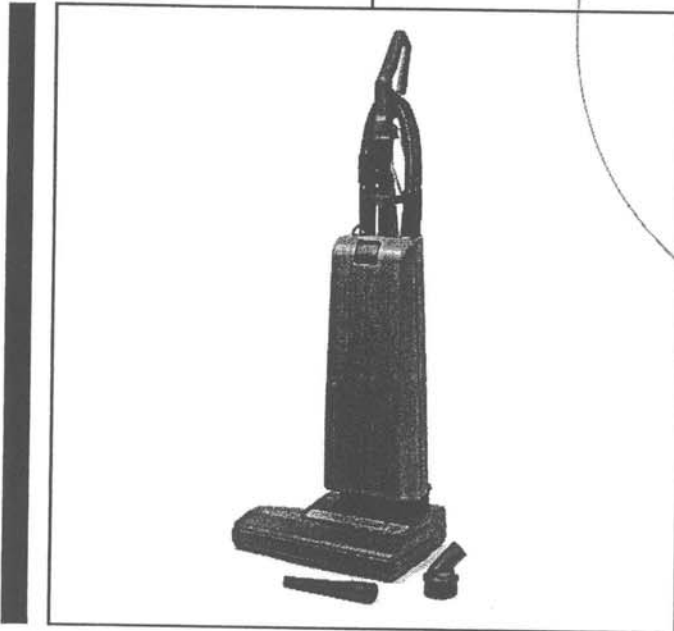

Better Resources. Better Results.
BETCO[®]

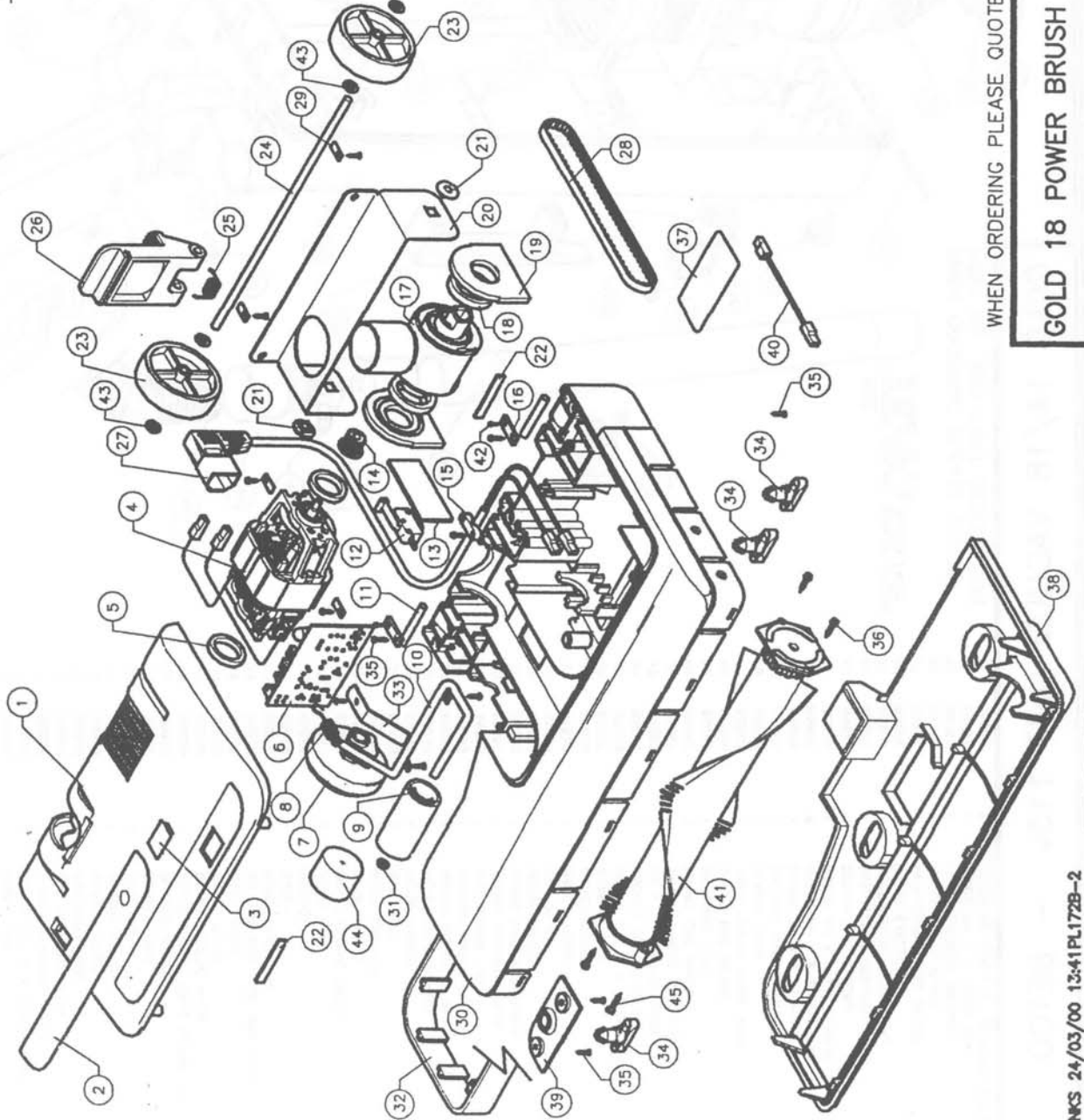

ITEM	PART No.	QTY.	DESCRIPTION
1	85877	1	POWER BRUSH TOP MOULDING
2	85878	1	TOP COVER 18 LABEL
3	85879	1	CLIP IN LENS
4	85880	1	110V 50 Hz 300W MOTOR
5	85881	2	MOTOR SUPPORT RING
6	85882	1	CIRCUIT BOARD - 110V
7	85883	1	HEIGHT ADJUSTMENT KNOB
8	86047	1	ROLLER ADJUSTMENT SPRING
9	85884	1	FLOOR ROLLER
10	85885	1	ROLLER AXLE
11	85886	2	PIVOT PIN
12	85887	1	MICRO SWITCH
13	85888	1	SWITCH PLATE
14	85889	1	COGGE DRIVE (MOTOR END)
15	85890	1	CABLE GRIP
16	85891	2	CLAMP PLATE
17	85892	1	TRUNNION
18	85893	2	TRUNNION SIDE FELT
19	85894	2	TRUNNION SIDE PLATE
20	85895	1	PRESS STEEL BRACKET
21	85896	2	SQUARE BUSH
22	85897	2	FELT SEAL
23	85898	2	WHEEL Ø66
24	85899	1	WHEEL AXLE
25	86025	1	PARK RELEASE SPRING
26	86026	1	FOOT PEDAL
27	86027	1	INPUT POWER CORD
28	85818	1	DRIVE BELT(XL 12B)
29	86028	5	CLAMP WASHER
30	86029	1	POWER BRUSH MIDDLE MOULDING LONG
31	86030	1	6mm STARLOCK CAP
32	86031	1	LONG BUFFER
33	86064	1	MOTOR FIXING BRACKET
34	86033	3	TURNBUTTON
35	86034	15	M4 x 20mm SPAX
36	86061	2	SCREW C/S 4 x 11mm SPAX
37		1	RATING LABEL
38	86036	1	470 BOTTOM FLOOR PLATE
39	86037	1	TURNBUTTON MOUNTING PLATE
40	86038	1	INTER CABLE (SWITCH TO PCB)
41	86073	1	470 BRUSH ROLL COMPLETE
42	86039	2	M4 X 12mm SPAX
43	86040	4	M6 WASHER
44	86041	1	FOAM RING SEAL
45	86059	2	SCREW C/S 4 x 18mm SPAX

WIRING DIAGRAM - 86049

WHEN ORDERING PLEASE QUOTE PART No. AND PART DESCRIPTION

GOLD 18 POWER BRUSH ASSEMBLY 115V 60Hz - BETCO



M.TONKS 28/03/00 15:24 PL1708-5

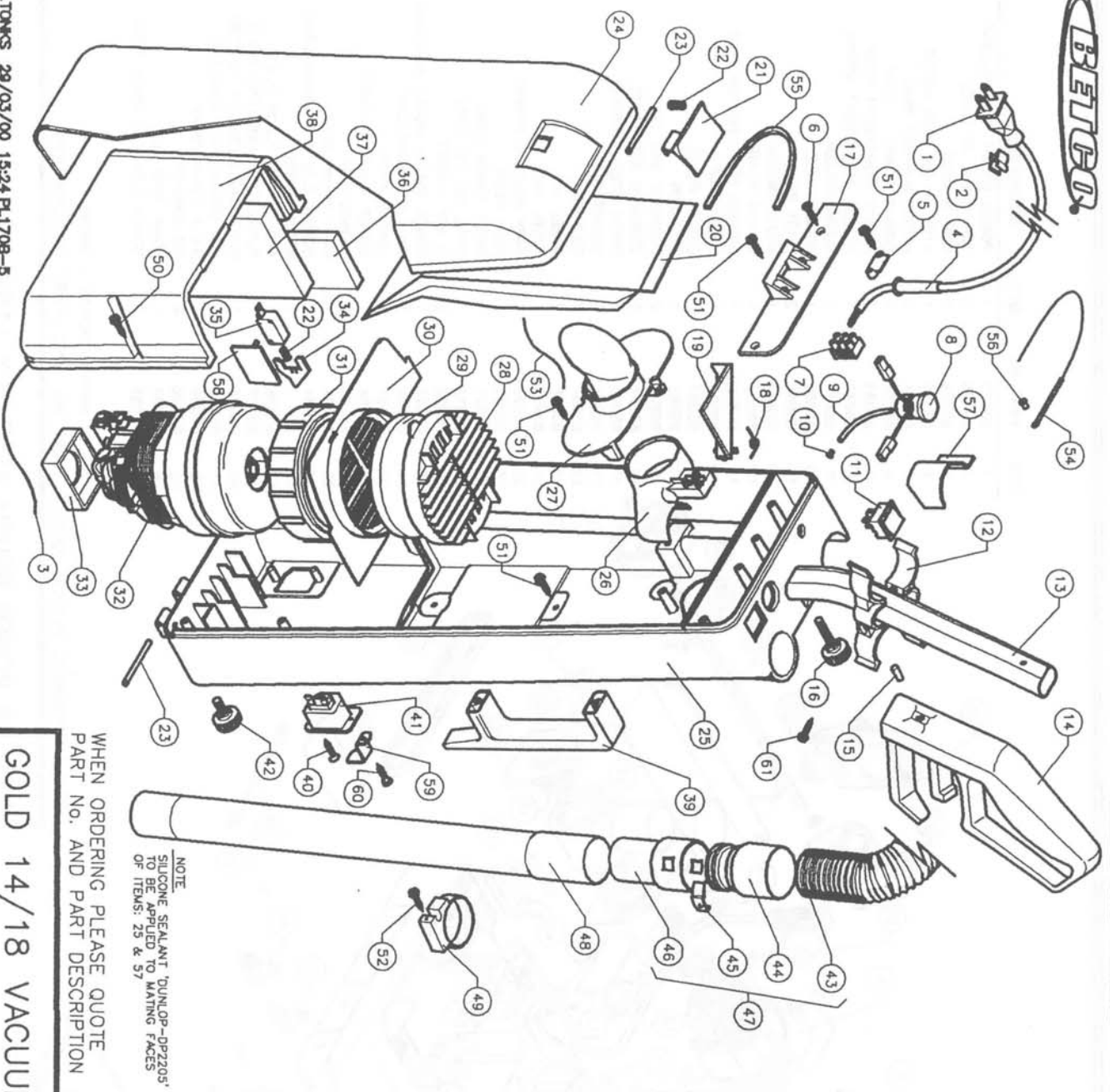

NOTE
SILICONE SEALANT 'DUNLOP-PP2205'
TO BE APPLIED TO MATING FACES
OF ITEMS: 25 & 57

WHEN ORDERING PLEASE QUOTE
PART NO. AND PART DESCRIPTION

ITEM	PART No.	QTY	DESCRIPTION
1	85820	1	MAINS LEAD 50' (1mm/2CORE)
2	85821	1	CABLE TIDY
3	85822	1	3mm EXPANDED CORD SEAL
4	85823	1	CABLE GROMMET
5	85824	1	CABLE GRIP
6	85825	2	SCREW C/S 4 x 20mm SPAX
7	85826	1	BAG FULL INDICATOR
8	85827	1	INDICATOR TUBE
9	85828	1	BRASS EYELET
10	85829	1	ON/OFF SWITCH
11	85830	1	TOOL CLIP
12	85831	2	HANDLE TUBE
13	85832	1	PLASTIC HANDLE
14	85833	1	M6x10 SOCKET GRUB SCREW DOG POINT
15	85834	1	M6x30 PLASTIC KNOB
16	85835	1	CATCH PLATE
17	85836	1	ARM SPRING
18	85837	1	NO BAG INDICATOR ARM (RED)
19	85838	1	PAPER DUST BAG
20	85819	1	CATCH
21	85839	1	SPRING
22	85840	2	HINGE PIN
23	85841	3	FRONT CASING (RED)
24	85842	1	REAR CASING
25	85843	1	INLET ADAPTOR
26	85844	1	BAG INLET
27	85845	1	FILTER COVER
28	85846	1	FILTER (BAG BURST)
29	85847	1	MOTOR MOUNTING PLATE
30	85848	1	VAC MOTOR 110V
31	85849	1	MOTOR MOUNTING PAD
32	86053	1	MICRO SWITCH
33	85851	1	EXIT FILTER
34	86065	1	BAFFLE FOAM
35	85853	1	MOTOR COVER
36	85854	1	REAR HANDLE
37	85855	1	SCREW C/S 3 x 12mm SPAX
38	85856	1	SOCKET OUTLET (2 PIN)
39	85857	1	M5 x 10 PLASTIC KNOB
40	85858	2	STRETCH HOSE (330mm)
41	85859	1	SWIVEL END INNER
42	85860	2	RETAINING CLIP
43	85861	4	SWIVEL END OUTER
44	85862	2	32mm SWIVEL HOSE ASSY
45	85863	2	PLASTIC TUBE
46	85864	1	SUCTION TUBE RETAINER
47	85865	1	SCREW PH 4 x 35mm SPAX
48	85866	4	SCREW PH 4 x 20mm SPAX
49	86066	1	SCREW PH 4 x 12mm SPAX
50	85868	1	300mm NYLON CORD
51	85869	1	ANTI-STATIC RESISTOR ASSY
52	85870	1	INLET NOZZLE DUST SEAL
53	85871	1	BRASS EYELET
54	85872	1	ANTI-STATIC LEAD COVER
55	85873	1	MICRO SWITCH PLATE
56	85874	1	PLUG RETAINING BRACKET
57	85875	1	SCREW PH 3 x 12mm SPAX
58	85876	1	SCREW PP No6 x 1" AB POINT S/TAP
59	86051	1	
60	86052	1	
61	86053	2	

GOLD 14/18 VACUUM UNIT 115V - BETCO

Upright Dry Vacuums

Operator's Manual



Gold 14
Gold 18

Item #85800
Item #85801

Better Resources. Better Results.
BETCO[®]

INTRODUCTION

This manual will help you get the most from your Betco Gold 14 Vacuum. Read it thoroughly before operating.

The Betco Vacuum is intended for commercial use.

PARTS & SERVICE:

Contact your BETCO AUTHORIZED DISTRIBUTOR for repair parts or service. Please specify the Model & Serial Number when discussing your machine.

NAME PLATE:

The Model & Serial Number of your machine is located on the Name Plate on the vacuum tank assembly. This information is often needed when ordering repair parts for the machine.

IMPORTANT SAFETY INSTRUCTIONS

**When using an electrical appliance, basic precautions should always be followed, including the following:
Read all instructions before using.**

! WARNING!

To reduce risk of fire, electric shock, or injury:

- * Do not leave the machine when it is plugged in. Unplug the unit from the outlet when not in use & before servicing.**
- * To avoid electric shock, do not expose machine to rain. Store indoors.**
- * Do not allow to be used as a toy. Close attention is necessary when used by or near children.**
- * Use only as described in this manual. Use only manufacturer's recommended attachments.**
- * Do not use with damaged cord or plug. If machine is not working as it should return it to a service center for inspection.**
- * Do not pull or carry by cord, use cord as a handle, close a door on a cord, or pull cord around sharp edges or corners. Do not run machine over cord. Keep cord away from heated surfaces.**

- * Do not unplug by pulling on cord. To unplug, grasp the plug, not the cord.
- * Do not handle plug or machine with wet hands.
- * Do not put any foreign object into openings. Do not use with any opening blocked; keep free of dust, lint, hair, & anything that may reduce airflow.
- * Keep hair, loose clothing, fingers, & all parts of body away from openings & moving parts.
- * Turn off all controls before unplugging.
- * Do not use in or around flammable or combustible liquids such as gasoline or use in areas where they may be present.
- * Connect to a properly grounded outlet only. See grounding instructions.

GROUNDING INSTRUCTIONS

This machine must be grounded. If it should electrically malfunction, grounding provides a path of least resistance for electric current to reduce the risk of electric shock. This machine is equipped with a cord having an equipment-grounding conductor & grounding plug. The plug must be plugged into an appropriate outlet that is properly installed & grounded in accordance with all local codes & ordinances.

! DANGER!

Improper connection of the equipment-grounding conductor can result in a risk of electric shock. Check with a qualified electrician or service person if you are in doubt as to whether the outlet is properly grounded. Do not modify the plug provided with the machine. If plug will not fit the outlet, have a proper outlet installed by a qualified electrician.

Replace the plug if the grounding pin is damaged or broken.

Extension cords connected to this machine should be 12 gauge, 3-wire cords with 3-prong plugs & outlets. **DO NOT** use extension cords more than 50 feet long.

PREPARING THE MACHINE FOR OPERATION

Safety check the cable and plug before starting.

Check the brush and remove any string or debris, which may be wrapped around the brush.

Check that a bag is fitted and is in good condition.

Plug the vacuum in to the power outlet.

Adjust the brush height to suit the carpet thickness. There are 4 settings; a setting of 1 allows maximum contact of the brush with the carpet.

Turn the main power switch on. The main vacuum motor will start.

Hold the handle and depress the red foot pedal. This will allow the handle to be lowered to a comfortable working position and at the same time, start the brush motor.

Vacuum the floor.

Using the Wand

Return the handle to an upright position.

Remove the wand by pulling it backwards and upwards. When the wand is removed the brush motor will stop automatically.

Use the crevice or upholstery tool as required.

After use, return the wand to its original position, ensuring that it fits correctly.

Dust Bag Full

This vacuum is fitted with a red "Bag Full/Blocked Hose" indicator. It will light if the airflow is obstructed.

If the light comes on, switch off and check the dust bag. If the dust bag is full, replace it with a new bag. If the bag is not full, check the wand to ensure it is not blocked.

Dust Bag Replacement

Open the door by pulling the door latch.

Hold the top of the dust bag with one hand and with the other, pull the bottom of the bag down and out. Seal the bag using the flap.

The vacuum cannot be closed until a new bag is fitted. Always fit a new genuine BETCO dust bag.

Changing the Inlet Filter

Remove the bag as described above.

Twist the filter cage anti-clockwise and lift.

Replace the filter with a new genuine BETCO filter and replace the filter cage.

CAUTION! Do not use the vacuum without an inlet filter.

Warning Lights

This vacuum is fitted with a 3 color-warning lamp. This lamp operates when the brush motor is working.

The GREEN lamp indicates that the brush is working correctly.

The ORANGE lamp indicates the drive belt is broken. The RED lamp indicates that the motor has stopped.

Belt and Brush Replacement

Turn the machine upside down and align the two clips with the front edge of the vacuum.

Lift off the brush cover and remove the brush roll. If required, fit a new belt around the motor spindle and the toothed wheel on the brush roll. Ensure that the rubber end caps are seated properly and refit the brush roll in the sockets.

AFTER USE

Unplug the power cord, starting from the machine wrap the power cord onto the tank assembly.

Completely empty tank filter of debris.

Wipe the entire machine with a clean, damp cloth.

Inspect the machine & all accessories for damage. Perform any required maintenance or repairs before storage.

Store the machine in a clean, dry place.