

KENT



MODEL:
THE PELICAN
PV-1000A
PV-1000A/PH
PORTABLE
VACUUM

COMMERCIAL USE

OPERATING,
MAINTENANCE
INSTRUCTIONS
& ILLUSTRATED
PARTS LIST

THE KENT COMPANY
P.O. Box 1665
2310 Industrial Parkway
Elkhart, IN 46515
TEL: (219)293-8661,
(800)334-1083
FAX: (219)295-8610
TELEX: 25-8331 KENT CO EKR

JULY 1992

GROUNDING INSTRUCTIONS

This appliance must be grounded. If it should malfunction or break down, grounding provides a path of least resistance for electric current to reduce the risk of electric shock. This appliance is equipped with a cord having an equipment-grounding conductor and grounding plug. The plug must be plugged into an appropriate outlet that is properly installed and grounded in accordance with all local codes and ordinances.

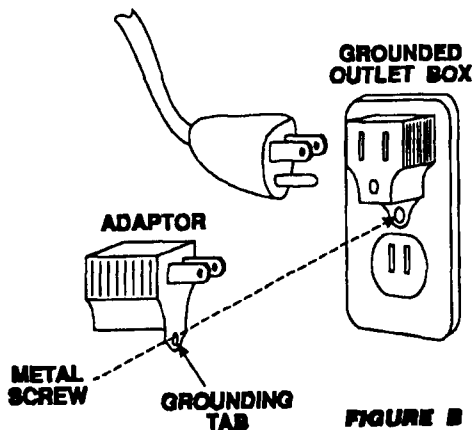
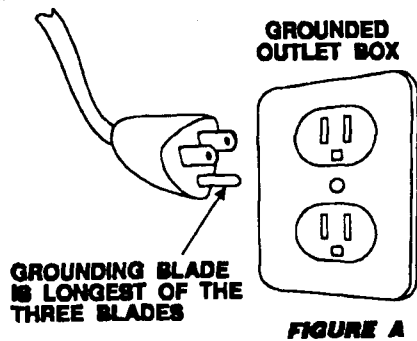

WARNING—Improper connection of the equipment-grounding conductor can result in a risk of electric shock. Check with a qualified electrician or service person if you are in doubt as to whether the outlet is properly grounded. Do not modify the plug provided with the appliance—if it will not fit the outlet, have a proper outlet installed by a qualified electrician.

If this appliance is for use on a nominal 120V circuit, it has a grounded plug that looks like the plug illustrated in Figure A. A temporary adapter that looks like the adapter illustrated in Figure B may be used to connect this plug to a 2-pole receptacle as shown if a properly grounded outlet is not available. The temporary adapter should be used only until a properly grounded outlet (Figure A) can be installed by a qualified electrician. The green colored rigid ear, lug, or the like extending from the adapter must be connected to a permanent ground such as a properly grounded outlet box cover. Whenever the adapter is used, it must be held in place by a metal screw.

Make sure that the appliance is connected to an outlet having the same configuration as the plug.

IMPORTANT SAFETY INSTRUCTIONS

When using an electrical appliance, basic precautions should always be followed including the following:

READ ALL INSTRUCTIONS BEFORE USING THIS APPLIANCE

WARNING:

To reduce the risk of fire, electric shock, or injury:

- Do not leave appliance when plugged in. Unplug from outlet when not in use and before servicing.
- To avoid electric shock, do not use outdoors or on wet surfaces.
- Do not allow to be used as a toy. Close attention is necessary when used by or near children.
- Use only as described in this manual. Use only manufacturer's recommended attachments.
- Do not use with damaged cord or plug. If appliance is not working as it should, has been dropped, damaged, left outdoors, or dropped into water, return it to a service center.
- Do not pull or carry by cord, use cord as a handle, close a door on cord, or pull cord around sharp edges or corners. Do not run appliance over cord. Keep cord away from heated surfaces.
- Do not unplug by pulling on cord. To unplug,

grasp the plug, not the cord.

- Do not handle plug or appliance with wet hands.
- Do not put any object into openings. Do not use with any opening blocked; keep free of dust, lint, hair, and anything that may reduce air flow.
- Keep hair, loose clothing, fingers, and all parts of body away from openings and moving parts.
- Do not pick up anything that is burning or smoking, such as cigarettes, matches, or hot ashes.
- Do not use without dust bag and/or filters in place.
- Turn off all controls before unplugging.
- Use extra care when cleaning on stairs.
- Do not use to pick up flammable or combustible liquids such as gasoline or use in areas where they may be present.
- For a grounded appliance: "Connect to a properly grounded outlet only. See Grounding Instructions."

SAVE THESE INSTRUCTIONS

Safety Recommendations

For long service life and safe use of your vacuum cleaner, we recommend the following guidelines:

Your cleaner is designed to pick up dirt and dust particles, it is not designed for water pickup. Avoid picking up hard or sharp objects with your cleaner to avoid bag breakage, hose clogging, or possible motor damage.

Be Safe - Avoid Possible Hazards

Powerhead model has exposed revolving brush rolls. Precautionary measures should be taken to confine long hair, loose clothing, fingers, etc., from contacting the brush roll when the cleaner is connected to an electrical outlet.

SERVICE INFORMATION

To obtain consistent performance over the life of your floor machine, read through these instructions and keep them handy for future reference. If you require service,

THE KENT CO. ELKHART, INDIANA USA		
SERIAL NO.		MODEL
VOLTS	PHASE	Hz
MOTOR 1	AMP	Hz
MOTOR 2	AMP	Hz

contact the dealer from whom the floor machine was purchased, or the authorized Kent Service Station. Always refer to your Kent Limited Warranty for complete service information.

Rating Plate

The model, type and serial number are indicated on the rating plate. For prompt and complete service information, always refer to these numbers when inquiring about service.

THE KENT PELICAN

Your Kent Pelican Vacuum Cleaner has been carefully engineered and manufactured to give outstanding performance in all cleaning operations.

Careful maintenance of the unit will insure that high standards of performance will be maintained thru its lifetime of operation.

HOW TO USE AND CARE FOR YOUR KENT PELICAN VACUUM

1. Always operate your Kent Pelican Vacuum on the proper voltage as outlined on the rating plate.

2. Before turning your vacuum on, be sure paper bag and kidney shaped filter are in place. To turn on, pull switch chain down, a second pull will turn vacuum off.

3. After using for dry application, remove the 51728 Kidney Shaped Filter and clean thoroughly. This must be cleaned daily to insure top performance. Remove paper bag and clean base before reusing vacuum, replacing paper bag when one-third full of materials. For added convenience, keep a supply of P/N 16420 Disposable Filter Bags or P/N 38634 Cloth Bag on hand. They may be obtained from your local Kent distributor.

4. If air movement is interrupted in your vacuum, check the P/N 51728 Filter to make sure it is clean. To see if hose has become plugged, remove hose from machine and test suction at machine intake. The vacuum motor is protected by a thermal cut-out switch so that extended use of the motor with interrupted air movement will automatically shut it off. When this situation occurs, the thermal switch must cool down for approximately 12 minutes before it will automatically reset. Remove all blockage in system before using vacuum again.

5. Store machine in clean dry place after removing all dirt from the tank and thoroughly cleaning the tools, hose and the outside of the unit.

6. The carbon motor armature brushes should be inspected after the first 400 hours of operation and frequently thereafter. They should be replaced when worn to 3/8 inch length. Permitting the brushes to be worn to less than 3/8 inch in length invariably will cause damage to the armature thus nullifying the guarantee. Always replace both brushes at the same time.

7. No other maintenance of the motor is required and none should be attempted during the first year after purchase.

8. Many tools are available for your Kent Pelican Vacuum. Contact your Kent Authorized Distributor for additional tools.

USING THE MOTORIZED NOZZLE

Assembly instructions for the motorized nozzle are included in the packaging. The motorized nozzle model KT-1241 is for use with models PV-1000 and PV-1000A vacuum cleaners only.

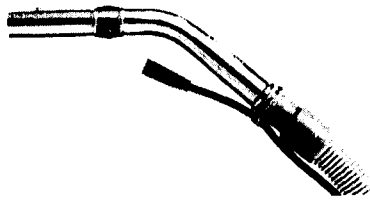

Insert the curved wand handle into the motorized nozzle wand.

An extension cord with a special fitting is provided to make the electrical connection between the motorized nozzle and your cleaner. Make the electrical connection between the motorized nozzle supply cord and the extension cord.

Attach the extension cord to the hose with the cord locator strips, spacing them evenly along hose. Once in place, the straps need not be removed from the hose.

Plug hose cord into power outlet located at side of vacuum cleaner motor cover.

Plug the cleaner power cord into an electrical outlet.



The motorized nozzle power switch operates with a touch of the toe also. Push to turn ON; push again to turn OFF.

NOTE: Both the vacuum cleaner and the motorized nozzle must be turned on to operate the motorized nozzle.

THE MOTORIZED NOZZLE IS DESIGNED TO BE USED ON CARPETING ONLY.

To Release the Motorized Nozzle Handle

Place foot lightly on top of nozzle housing along either side of handle socket while lowering handle from upright to comfortable work position. When not in use, unit will stand upright. When using other cleaning tools, BE SURE TO DISCONNECT the hose cord from the cleaner outlet.

Edge Cleaner

Edge Cleaner feature provides for improved cleaning of carpets near walls and stationary furniture. Slots on the sides of nozzle increase air flow to the edges of the cleaner and add to the cleaning efficiency of the cleaner. To operate, simply run cleaner along edge board. Edge Cleaner operates instantly and automatically.

Carpet Cleaning Adjustment

The nozzle height is instantly and automatically adjusted to any carpet pile length. The floating head feature of your motorized nozzle allows the nozzle to float evenly and parallel to all carpet surfaces without manual adjustment.

HOW TO USE YOUR CLEANING TOOLS

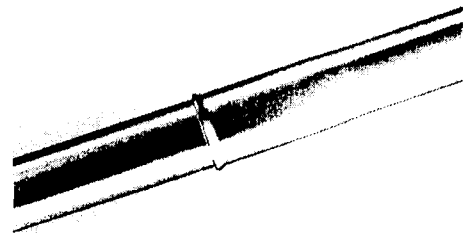

To use your cleaning tools, slip the straight end of the wand into the circular end of the tools with a twisting motion until it is secure. Use curved wand with the floor and wall brush, pushing dimpled end into nozzle open-

ing until wand "clicks" in and brush turns freely.

Join the two chrome handle sections by inserting the buttonlock end of one section into the larger end of the second section.

THE BRUSH ROLL BELT

The brush roll belt on the motorized nozzle drives the brush roll to provide agitation, sweeping action, and combing of the nap.

When to Replace

The brush roll belt should be checked regularly to be sure it is in good condition. Check to see if the belt has stretched or cracked or if excessive slipping is occurring. Replace if needed.

How to Replace a Worn Belt

NOTE: Be sure to disconnect unit from electric supply before replacing belt.

Remove chrome bottom plate by removing the two phillips screws on bottom of unit.

Remove the worn or broken belt from the brush roll pulley and the motor drive shaft.

Loop the new belt around the center of the motor drive shaft. Slip the opposite loop of the belt between the brush roll pulley and the nozzle housing.

Using the thumb and the finger, rotate the belt on the pulley, wrapping the belt all the way around the pulley.

Place the lip on front of the chrome bottom plate over the ridge across the front of the nozzle.

Secure the chrome bottom plate by replacing the two phillips screws.

Be sure to use only KENT replacement belts. Ask for Brush Roll Belt P/N E35967.

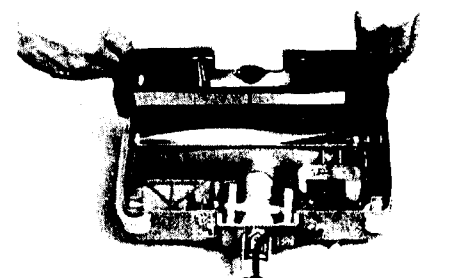
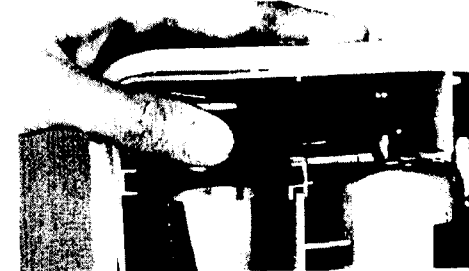
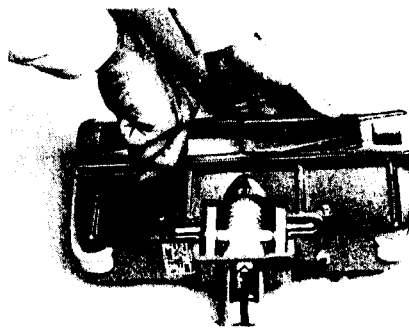

PARTSLISTS

FIGURE A

DET	PART NO.	DESCRIPTION	QUANT
1	025562	CORD, POWER—18-3, SJT, BLK, 50'HT	1
1	026675	CONN, PLUG—3-WR, 15A, 125V, HOSPI	1
2	026708	SWITCH-PULL CHAIN	1
3	053094	BSHG, STRAIN RLF—, 31-.37 ACCOM	1
4	048808	LABEL, IDENT—KENT, 1.50X6.00BLU	1
5	051241	PLATE, INSULATION-ABS PLASTIC	1
6	003411	NUT, HEX— 10-24, NYLON	2
7	005554	SCR NYL RD HD 10-24X.625L	2
8	004253	WSHR LK .204ID.410OD.025T EXT	2
9	052367	TOP SHROUD, MACHINED—PV100AWHTI	1
10	001345	SCR TPG F PAN HD 10-24X.250L	1
11	E48373	BRUSH, MTR—FOR 331394	2
12	023371	ASM, MOTOR—VAC, PELICAN 1000	1
12	023377	ASM, MOTOR—VAC, PELICAN-230V	1
13	400502	HOOK MOTOR CLAMPING	2
14	052304	GASKET, NEOPRENE—7.00X7.00X.18	1
15	033684	WDMT, PLATE—MTG, MOTOR, PV100A	1
16	111384	BUSHING 1 7/32X3/16	2
17	051729	FOAM FILTER 'KIDNEY SHAPE'	1
17	661842	MICROSTAT FILTER PKG OF 12, 18I	1
18	001327	SCR MACH PAN HD 10-24X.750L	8
19	004253	WSHR LK .204ID.410OD.025T EXT	8
20	052303	SEAL—FLEXIBLE TRIM, .25X39.50L	1
21	051322	EYELET—SHOULDER STRAP PELICAN	3
22	051323	PLATE, BACKING—SHLDR STRP EYLT	3
23	E49028	NUT, SPECIAL—HANDLE	2
25	046810	PORT, INTAKE-MACHINED	1
26	051317	BODY, MACHINED PELICAN	1
27	051326	HANDLE—PELICAN 'VINYL-BLACK'	1
28	051321	ENDCAP—HANDLE 'PELICAN-ZINC'	2
29	033350	ASM, DEFUSER—EXHAUST	1
30	002263	SCR MACH RD HD .250-20X1.25L	2
30	003283	NUT, HEX—, .250-20, ZN PLT	2
30	005213	WSHR FLT .281ID.562OD.063T STL	2
31	223188	SCR MACH PAN HD 6-32X.500L	2
32	E36427	PLATE-COVER	1
33	051164	ASM, RECEPTACLE & TERMINAL—	1
34	004250	WSHR LK .148ID.250OD.031TSPLT	6
35	003418	NUT, ACORN— 6-32, NYLON, .325H	2
36	002416	SCR TPG F PAN HD 10-B X.375L	4
37	051327	STRIKE, BODY LATCH—PELICAN ZN.	2
38	004253	WSHR LK .204ID.410OD.025T EXT	1
39	051459	MOTOR PROTECTOR—'MODIFIED'	1
40	224015	WSHR FLT .187ID1.00OD.063T STL	2
41	222223	NUT, HEX LOCK— 10-32, ZINC	2
42	052305	WIRE, STL—12GA, FILTER RETAINER	1
43	016420	DISP FILTER BAG PK OF 10	1
43	038634	BAG, CLOTH— PV1000 'SERVICE'	1
44	016417	SHOULDER STRAP	2
45	005323	WSHR FLT .203ID.500OD.036T STL	4
46	051324	LATCH—PELICAN 'ZINC PLATED'	2
47	004492	RIVET, POP—, .187 DIA, .375 MAX	4
48	051325	STRIKE, DOLLY LATCH—PELICAN ZINC	2
49	046819	INTAKE GASKET	2
50	046820	INTAKE FLANGE	2
51	E49026	SCR—HANDLE	2
52	046822	INTAKE	2
52	051807	TUBE, BRS—FLANGED, 1.50OD, 4.0L	1

FIGURE B

DET	PART NO.	DESCRIPTION	QUANT
1	003440	SCR TPG F PAN H 8-BTX.500L	2
2	E25788A	ASM, SOLE PLATE—SERVICE ITEM	1
3	E36995	BELT, DRIVE—SERVICE, HATBOX	1
4	E36680A	COVER—GROUNDING, KT151, PV1000	1
5	E35717-2	SWITCH	1
6	E49110A	GUARD, BELT—POWERHEAD ASM	1
7	E13286C-3	ASM, HOUSING—POWER HEAD	1
8	222244	NUT, WIRE—IDEAL 71 B	3
9	003274	NUT, HEX— 6-32, ZN PLT	1
10	E26217	MTR, AC—120/60., 12HP, PWR NOZ	1
11	002398	SCR MACH PAN HD 8-32X.250L	2
12	E36237A-2	GUARD, FURNITURE—SERVICE ONLY	1
13	E36789-5	ASM, SOCKET—HANDLE	1
14	E55505	BRG—KT SERIES POWERHEAD, SRVCE	2
15	E36555-1	WHEEL—2.25DIA, 260BORE., 558HB	2
16	E48334	AXLE	1
17	038674	ASM, HOSE, COMPLETE—KT-150	1
18	003439	SCR TPG F PAN HD 8-BTX.500L	2
19	E12578B-1	DIVIDER, INLET—KT151, PV1000	1
20	E25700B	ASM, DISTRIBUTOR SVC—	1
21	E37114	PULLEY—KT151, PV1000	1
22	E25918	SHAFT-DISTURBULATOR	1
23	E49865	SPACER—SERVICE ITEM	2
24	E25699A	ASM, DISTURBULATOR—BEARING	1
25	E35664B	BEATER BAR-SHORT	1
26	E35895-1	SUPPORT-BEATER BAR SHORT	1
27	E49175A	NUT, HEX, LOCK—KT151, PV1000	1
28	E35665B	BAR-BEATER LONG	1
29	E35895-2	SUPPORT-BEATER BAR LONG	1
30	E36558A	COVER-PLATE	2
31	E49145	RING, RTNG—EXT., 250 SHAFT, 5304	1
32	E49436	BSHG, SLV—, 663OD.313ID.500L PL	1
33	E25743	ASM, BRISTLE STRIP—LONG, KT151	1
34	E13173	EXTRUSION—DISTRIBUTOR, KT151	1
35	E49435	COUPLING-DRIVE	1
36	E25744	ASM—BRISTLE STRIP, SHORT, KT151	1
37	E49500A	WSHR FLT .255ID.437OD.062T STL	2

FIGURE C

DET	PART NO.	DESCRIPTION	QUANT
1	E36879-2	ASM—STRAIGHT WAND & SPRING	2
2	E13466	WAND—STRAIGHT, KT151, PV1000	1
3	E49504	RIVET—SHOULDER, KT151, PV1000	1
4	E25986-2	CHANNEL, CORD—KT151, PV1000	1
5	E25414-3	CORD, POWER—18-3, SJT, BLK, EXTSN	1
6	E35708-3	STRAP-SUPPLY CORD LOCATOR	10
7	E25415-2	CORD, POWER—18-3, SVT, BLK, 46IN	1
8	032547	ASM, HOSE—VAC	1
9	E36472-1	CUFF	2
10	051134	HOSE 5' LONG	1
11	016544	ASM, HOSE—	1
12	E36371-1	CUFF-HOSE	1
13	051582	HOSE VACUUM— 5FT. LONG, GRAY	1
14	E35049-1	CUFF-HOSE	1
15	E35179	SLEEVE	1
16	E36396	ASM, TUBE—CURVED HANDLE	1
17	016419	DETACH WHEELS	1
18	003274	NUT, HEX— 6-32, ZN PLT	4
19	223188	SCR MACH PAN HD 6-32X.500L	4
20	051463	DOLLY, MACHINED—PELICAN, WHITE	1
21	051879	LATCH—CADDY, PELICAN VAC	2
22	003354	NUT, ACORN— 375-16, ZN PLT	4
23	004214	WSHR LK .390ID.683OD.094TSPLT	4
24	005483	WSHR FLT .438ID1.00OD.104T STL	4
25	051176	SPACER, PLSTC—, 390X1.00, .500L	4
26	051183	CASTER WHEEL - PELICAN	4

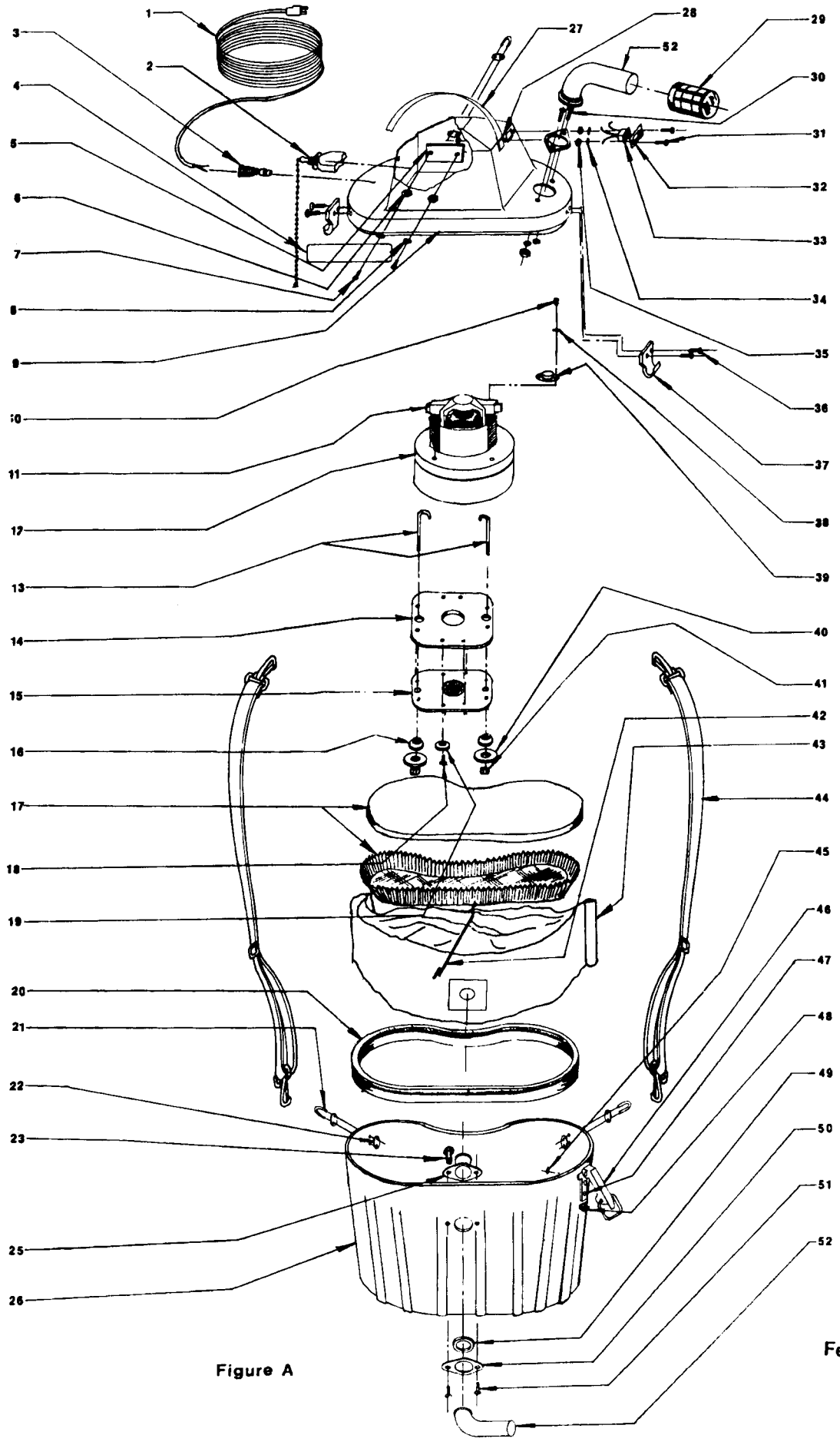
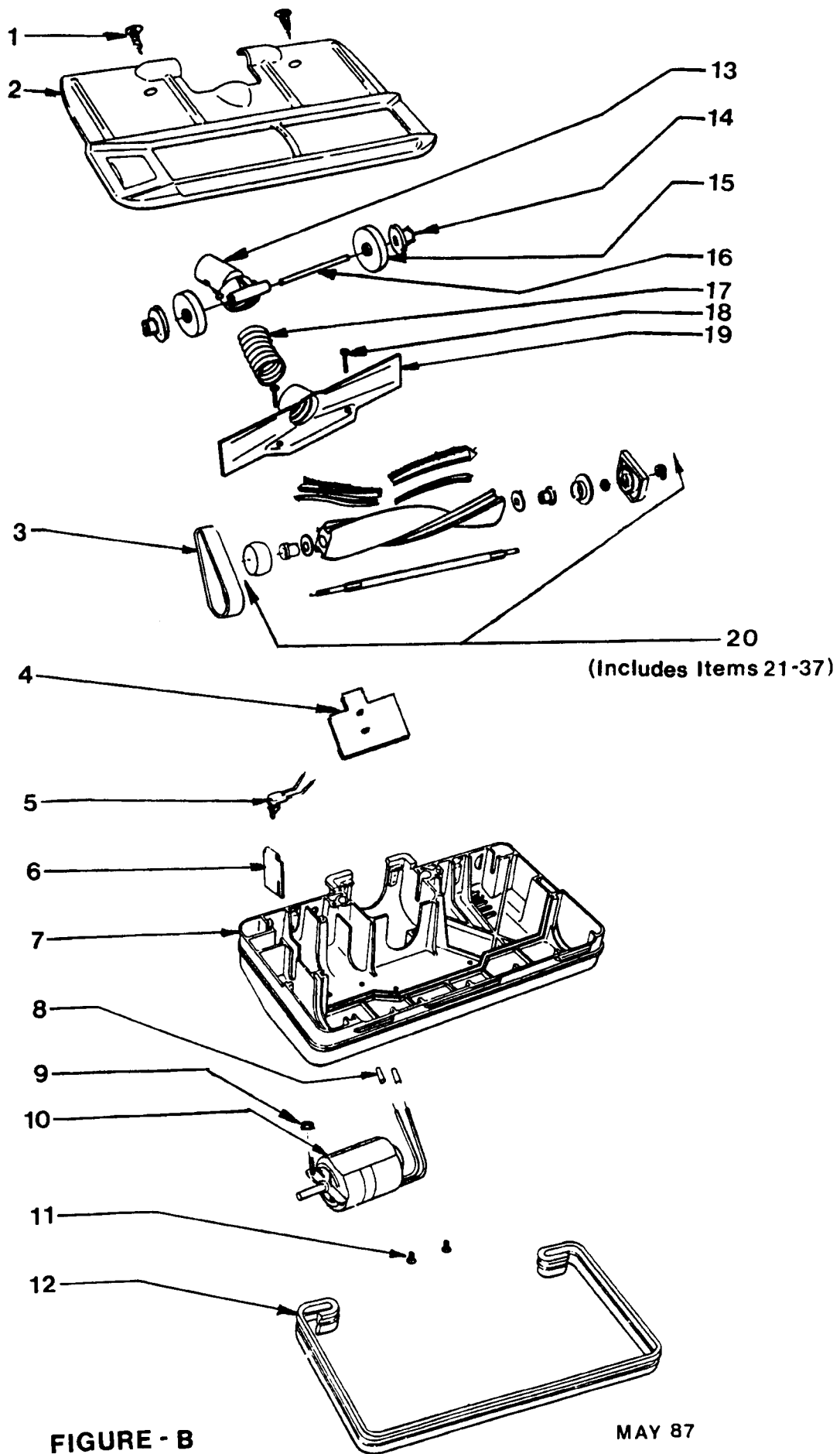

Figure A

Feb, 84



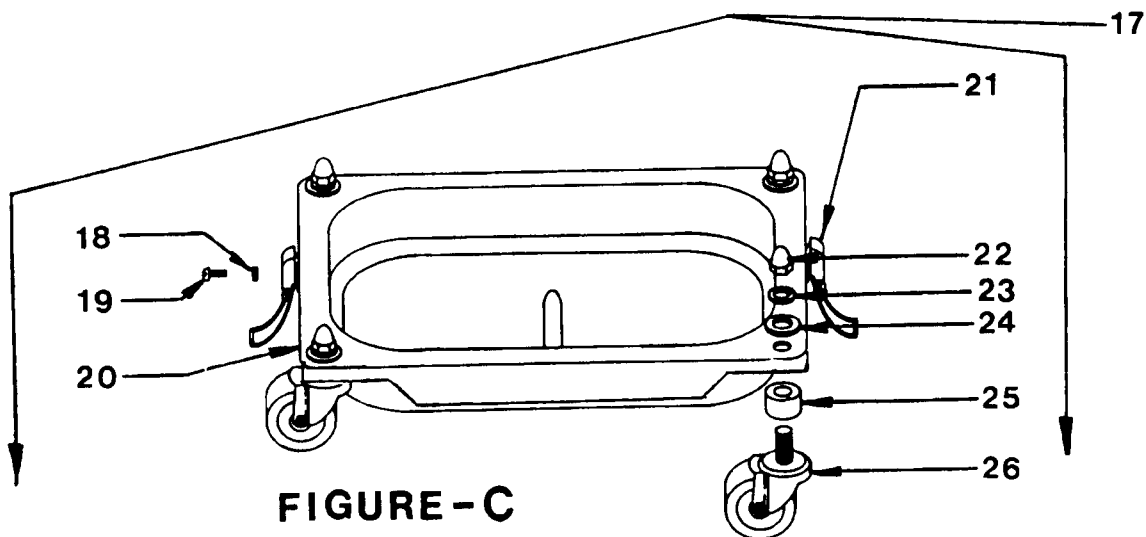
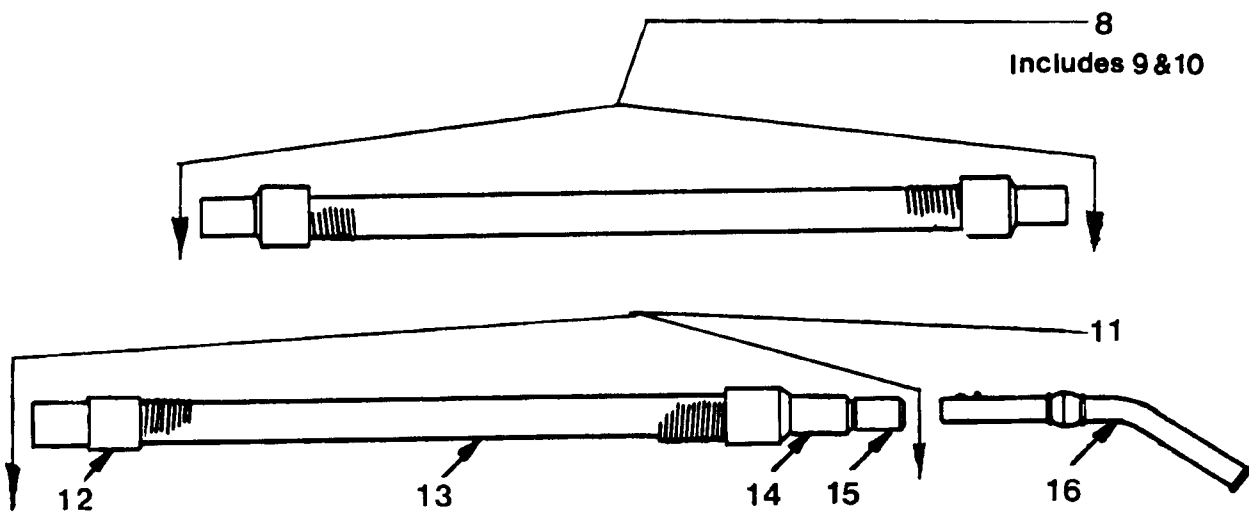
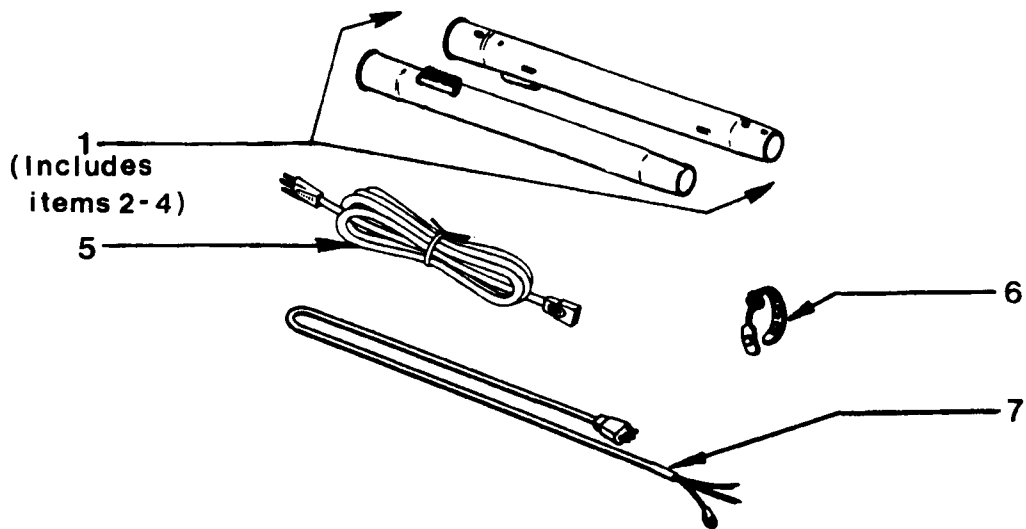
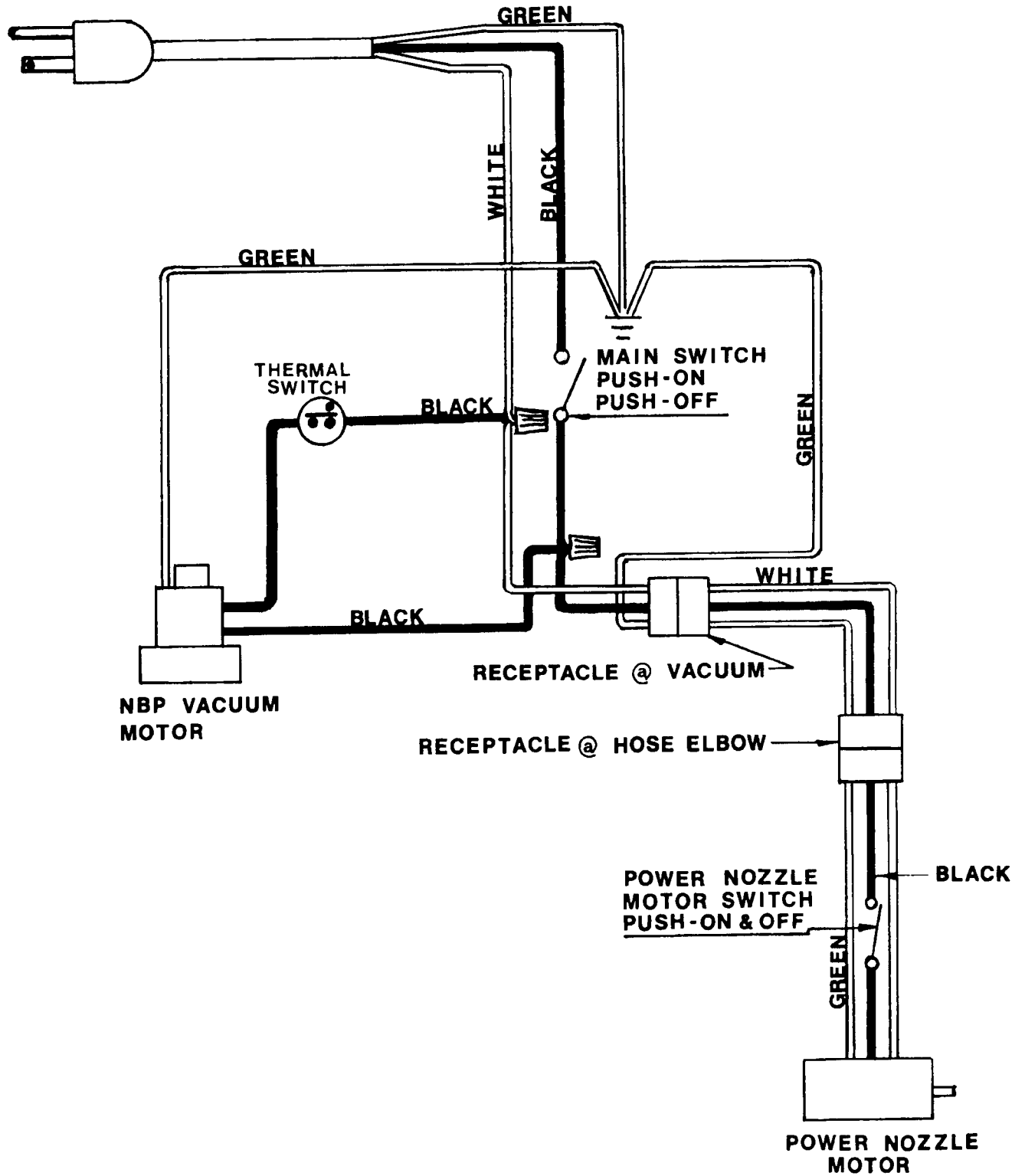

FIGURE - C

NOTES

WIRING DIAGRAM



THE KENT LIMITED WARRANTY

Your Kent equipment which has been manufactured, tested and inspected in accordance with carefully specified engineering requirements, is warranted to be free from defects in material and workmanship. This warranty is, however, subject to the following qualifications, conditions, and limitations which are set forth to provide you and all users of the Kent equipment with information concerning the duration, extent, availability, and applicability of this Kent limited warranty, the procedure to be taken to obtain its performance, and other information concerning the Kent warranty policy.

The Kent Limited Warranty is extended to the original end user as follows:

KC180, KC280, KC200, PV1000A, KT151 and KD3S 3 year parts replacement and 1 year service labor warranty.

Upright carpet vacuums KSR14, KX20SC, KS270, KT151 power head and PV1000A power head 1 year parts replacement and service labor warranty.

KC110A upright 90 days parts replacement and service labor warranty.

Replacement parts guaranteed for 90 days from date of installation against defects in material and workmanship.

The 10 year poly component replacement warranty with 1 year service labor extends for a period of ten (10) years from the date of the original purchase of the Kent equipment by the original purchaser. This warranty will not cover damage attributable to the following:

- (1) Improper, unreasonable or negligent use or abuse of the equipment.
- (2) Use of equipment with hot water or high temperature above 130 degrees Fahrenheit (54 degrees centigrade).
- (3) "Warpage", "Creepage", or "Distortion" of part so long as the same does not interfere with normal operation.
- (4) Abrasions or punctures of the equipment.

The start date of the warranty coverage shall be the purchase date of the original end user or six months from the date the machine was shipped from the factory, whichever comes first.

PARTS OF KENT EQUIPMENT NOT COVERED BY WARRANTY

Certain parts of Kent equipment require replacement in the ordinary course of use due to normal wear by reason of their characteristics. These are normal wear items such as cords, gaskets, switches, bumpers, carbon brushes, handle grips, bags, hoses, bearings, etc.

EXCEPTIONS AND EXCLUSIONS FROM WARRANTY

This equipment is required to be used on electric current as indicated on the data plate. Otherwise damage, defects, malfunctions or other failures of the equipment arising from use on electric current not as indicated are excepted and excluded from this warranty. Defects, malfunctions, failure or damage of the equipment caused by improper, unreasonable or negligent use or abuse while in the possession of the purchaser are likewise excluded from this warranty. If repair is done on your equipment by anyone other than those designated as authorized to perform such work without first having obtained factory instructions, The Kent Company, at its sole option, may determine that this warranty will not apply and that reimbursement for such repair will not be made because of the failure to comply with such factory specified instructions.

PROCEDURE TO BE TAKEN TO OBTAIN PERFORMANCE OF WARRANTY REPAIR

To secure repair of the equipment or any warranted parts under this warranty, the following procedure should be taken. The inoperative equipment or warranted parts, together with satisfactory evidence of the purchase date, must be delivered, with shipping and delivery charges prepaid, to one of the following:

- (1) The dealer from whom purchased;
- (2) Any Kent distributor's service department in the United States;
- (3) Any Kent authorized service station in the United States.

If you are unable to locate any of the foregoing, you may write or otherwise communicate with The Kent Company for instructions before repair service is performed by anyone else. In such event, The Kent Company will provide either the location of a closely available Kent distributor service department or Kent authorized service station or other factory instructions. Upon compliance with the above procedure, all warranted defects will be repaired, at no additional charge or costs to the customer, and the repaired product returned to the customer, with all shipping and delivery charges prepaid. In following the procedures above set forth, PLEASE MAKE CERTAIN to state the Kent model, type and serial number as shown on the data plate of the equipment.

REPLACEMENT

In the event of a defect, malfunction or failure of your Kent equipment or any warranted part to conform with this warranty, The Kent Company may, at its sole option and own expense, replace the equipment or any warranted part with another new identical or reasonably equivalent model or part in lieu of repairing the defect.

NO REFUND OF PURCHASE PRICE

The Kent Company will not, as a matter of its warranty policy, refund the customer's purchase price.

WARRANTY REGISTRATION CARD FOR YOUR KENT EQUIPMENT AND REQUEST FOR INFORMATION

Your Kent Company distributor from whom you purchased your equipment is responsible for the registration of your warranty with the factory. We ask that you cooperate with your distributor in supplying the necessary information on the warranty card so that we may better serve you. Any information or questions you may have concerning your Kent equipment or this warranty may likewise be secured from the factory. This warranty gives you specific legal rights, and you may also have other rights which vary from state to state.

THE KENT COMPANY

P.O. BOX 1665 ELKHART, INDIANA 46515

083062